



# REVOLUTION™

## 3 BURNER



**FLARE FREE**  
**TECHNOLOGY™**

## ASSEMBLY MANUAL

85-3166-6 (G53205)

### **LIMITED 5-YEAR WARRANTY**

Read and save manual for future reference.

Assemble your grill immediately. Missing or damaged parts should be claimed within 30 days of purchase.

For product inquiries, parts, warranty and troubleshooting support, please call 1-800-275-4617.



## HEAVY ARTICLE NEEDS 2 TO LIFT

### **THIS MANUAL MUST REMAIN WITH THE PRODUCT AT ALL TIMES**

To ORDER non-warranty replacement parts or accessories,  
or to register your warranty, please visit us on the web at  
**[www.colemanbbqs.com](http://www.colemanbbqs.com)**

#### **⚠ CAUTION**

Sharp edges. Wear gloves when assembling your grill.

#### **⚠ CAUTION**

Read and follow all safety statements, assembly instructions, use and care directions before attempting to assemble and cook.

#### **⚠ INSTALLER OR ASSEMBLER/ CONSUMER**

This manual should be kept with the barbecue at all times.

#### **⚠ WARNING**

Failure to follow all of the Manufacturer's instructions could result in hazardous fires, explosions, property damage, or serious personal injury or even death.

Follow all leak check procedures carefully prior to operation of barbecue, even if grill was dealer assembled. Do not try to light this barbecue without reading the Lighting Instructions section of this manual.

#### **⚠ DANGER**

1. If you smell Gas:
  - a. Shut off gas to the appliance
  - b. Extinguish any open flame
  - c. Open lid
  - d. If odor continues, keep away from the appliance and immediately call your gas supplier or your fire department
2. Requires two people to complete the assembly process.
3. Beware of sharp edges.

#### **⚠ WARNING**

1. Do not store or use gasoline or other flammable liquids or vapours in the vicinity of this or any other appliance.
2. An LP cylinder not connected for use shall not be stored in the vicinity of this or any other appliance.

#### **⚠ WARNING**

IN DIRECT SUN, AND IN OPERATION, YOUR BARBECUE'S STAINLESS STEEL AND PAINTED STEEL PARTS CAN BECOME VERY HOT.

**THIS BARBECUE IS FOR OUTDOOR USE ONLY**

**CONTACT CALL CENTRE IF ANY PARTS ARE MISSING**

**1-800-275-4617**

# HARDWARE PACK

## TOOLS NEEDED FOR ASSEMBLY

- #2 Phillips screwdriver (long and short)
- 1/4" Slotted screwdriver (long and short)
- Adjustable wrench
- Pliers

No.	Description	Part Number	Qty.
1	1/4"-20UNCx38 Screw	20120-13038-250	6
2	1/4"-20UNCx16 Screw	20120-13016-250	26
3	NO.10-24UNCX13 Screw	20124-10013-250	18
4	NO.8-32UNCX18 Screw	20132-08018-250	2
5	NO.8-32UNCX10 Screw	20332-08010-250	3
6	ST4.2X10 Tapping Screw	22500-42010-137B	9
7	Rubberized Washer	G501-0054-9100	10
8	1/4"-20UNC Nut	30220-13000-250	2
9	NO.8-32UNC Nut	30232-08000-250	2
10	Wheel Lock Pin	G350-0026-9000	1

**⚠ Caution:**  
Sheet metal can cause injury. Wear gloves when installing the grill.

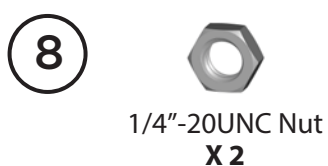

## BEFORE ASSEMBLING THIS BARBECUE, READ THE INSTRUCTIONS CAREFULLY.

Assemble the barbecue on a flat, clean surface. Grill is heavy. Two people are recommended to assemble this barbecue.

## PARTS LIST FOR 85-3166-6 (G53205)

Item No.	Qty.	Description	Part No.
AA	1	Top Lid Assembly	G532-2000-02
AB	1	Lid Handle	G532-0004-01
AC	1	Thermometer	G532-0007-01
AD	1	Thermometer Bezel	G532-0006-01
AE	2	Screw, Top Lid	G466-0007-01
AF	2	Lid Bumper, Front	G527-0002-02
AG	2	Lid Bumper, Rear	G303-0038-01
BA	1	Burner Box Assembly	G532-3100-01
BB	3	Main Burner	G532-3500-01
BC	2	Carryover Assembly	G532-0014-01
BD	3	Heat Distribution Plate	G532-0016-01
BE	1	Grease Channel	G532-0015-01
BF	6	Cooking Grate	G532-0017-02
BG	1	Cleaning Tool	G532-0049-01
BH	1	Warming Rack	G532-0018-01
BI	1	Match Holder	G501-0068-01
BJ	1	Grease Channel Shield	G532-0063-01
CA	1	Manifold Assembly, LP	G532-8800-01
CB	1	Regulator	G501-0060-01
CC1	1	Electronic Ignition Assembly	G532-0019-01
CC2	1	Ignition Battery Cover	G532-0019-02
CC3	1	Instastart™ Ignition Button	G532-0082-01
CC4	1	Ground Wire	G602-0024-01
CD	1	Electrode Set, Main Burner	G515-0067-01
CE	3	Control Knob	G532-3600-01
CF	3	Knob Bezel	G363-0026-01
CG	1	Control Panel	G532-0075-01
CH	1	Front Brace	G532-9000-01
CI	1	Grease Cup, Burner Box	G416-0015-01
CJ	2	Grease Cup Rails	G466-0034-01
CK	1	Upper Back Panel	G532-0067-01
CL	1	Lower Back Panel	G532-0066-01
CM	1	Heat Shield, Burner Box	G532-0023-01
CN	1	Heat Shield, Tank	G532-0033-01
CO	1	Tank Exclusion Wire	G532-0077-01

Item No.	Qty.	Description	Part No.
DA	1	Side Shelf Table, Left	G532-0030-01
DB	1	Side Shelf Fascia, Left	G532-C600-01
DC	1	Side Shelf Table Rear Brace, Left	G532-1300-01
DD	1	Side Shelf Table, Right	G532-0030-01
DE	1	Side Shelf Fascia, Right	G532-A600-01
DF	1	Side Shelf Table Rear Brace, Right	G532-1700-01
DG	1	Grease Cup Holder, Flare-Free	G532-0031-02
DH	1	Grease Cup, Flare-Free	G532-0031-02
EA	1	Cart Side Panel, Left	G532-1000-02
EB	1	Cart Side Panel, Right	G532-1100-02
EC	1	Left Door Assembly	G532-9100-01
ED	1	Right Door Assembly	G532-9200-01
EE	2	Door Handle	G532-0026-01
EF	1	Bottom Shelf	G532-0600-02
EG	2	Locking Castor	G350-0023-01
EH	2	Castor	G350-0024-01
EI	2	Door Magnet Assembly	G527-0037-01
F1	1	Hardware Pack	G532-B005-01
F2	1	Assembly Manual	G532-M005-01
F3	1	Safe Use and Care Manual	G363-M002-02
F4	1	Tank Screw	G505-0047-01

# EXPLODED DIAGRAM FOR 85-3166-6 (G53205)

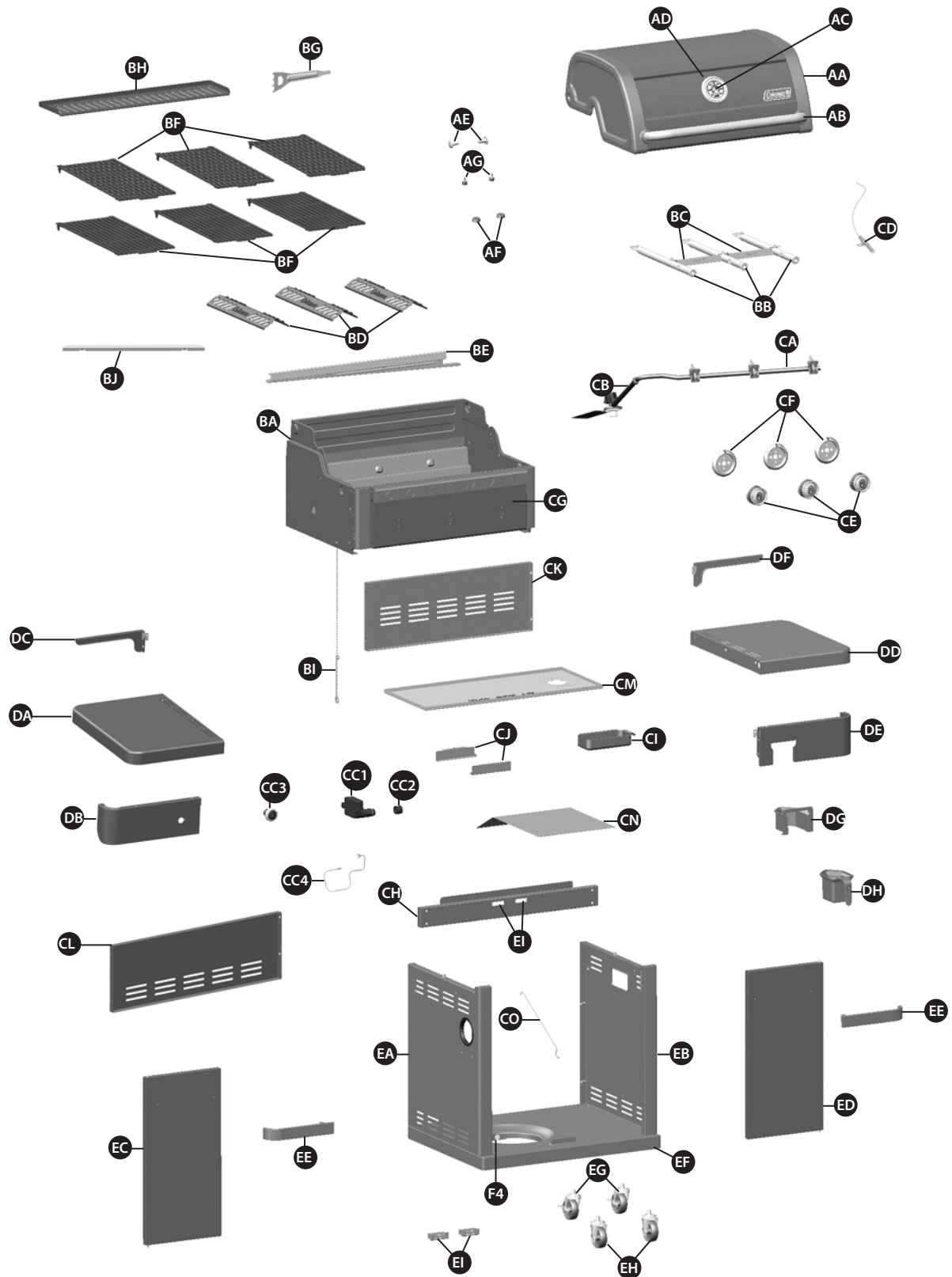

## Extras

Hardware  
Pack  
**F1**

Assembly  
Manual  
**F2**

Safe Use  
& Care  
Manual  
**F3**

# ASSEMBLY INSTRUCTIONS

1

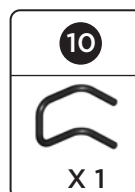
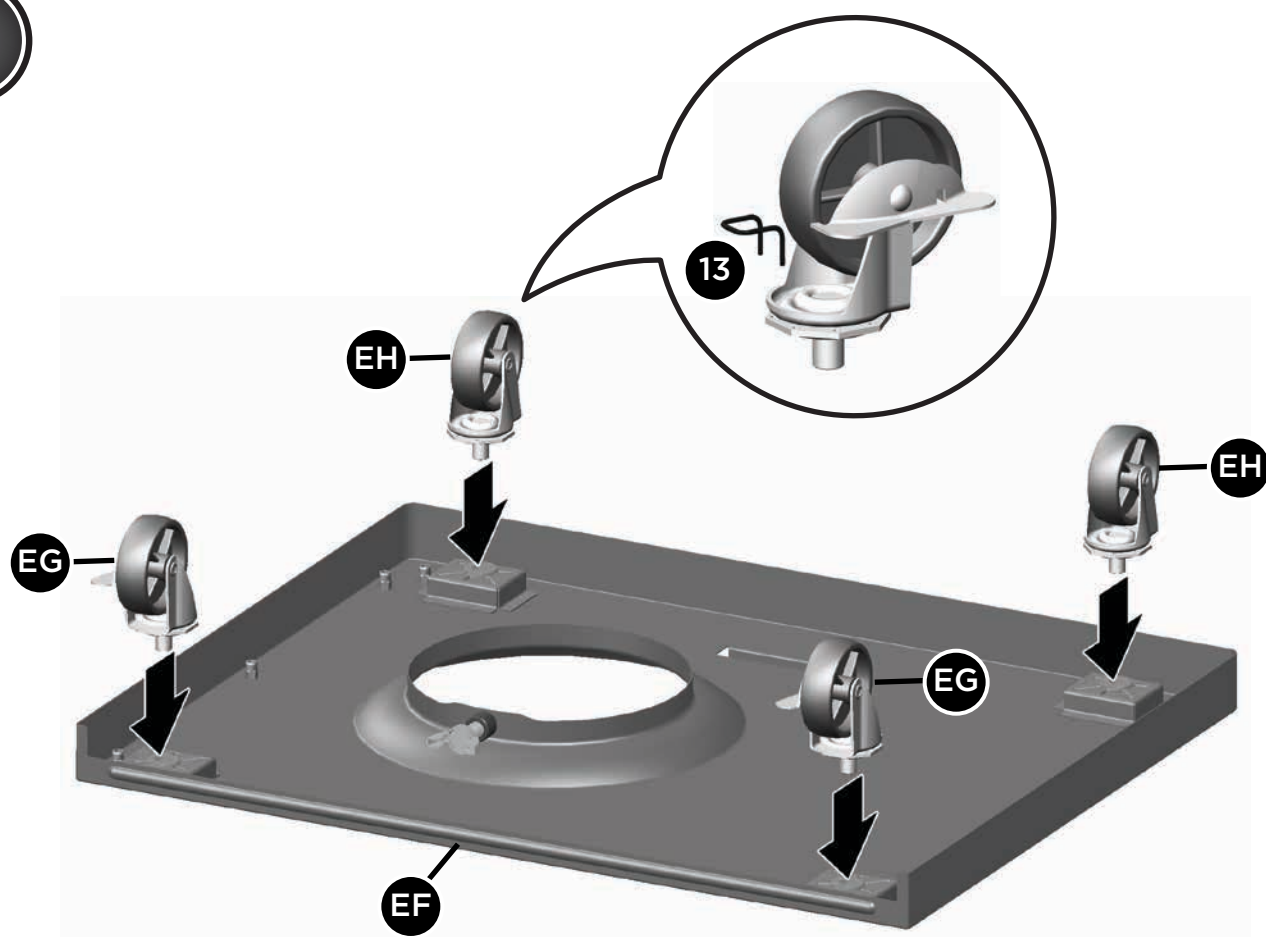

# ASSEMBLY INSTRUCTIONS

2

2X

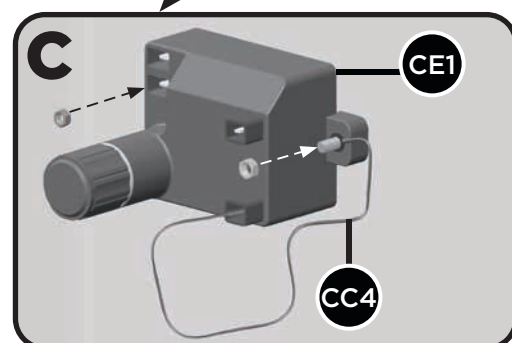
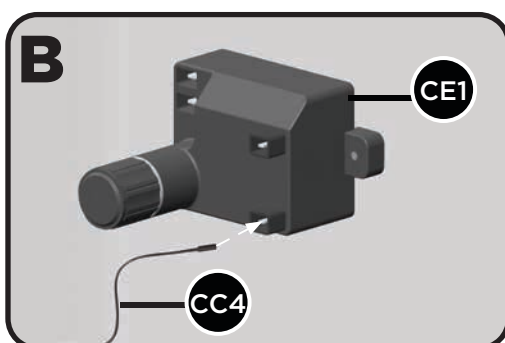
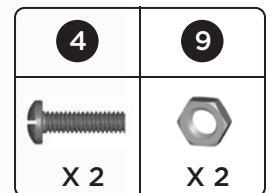
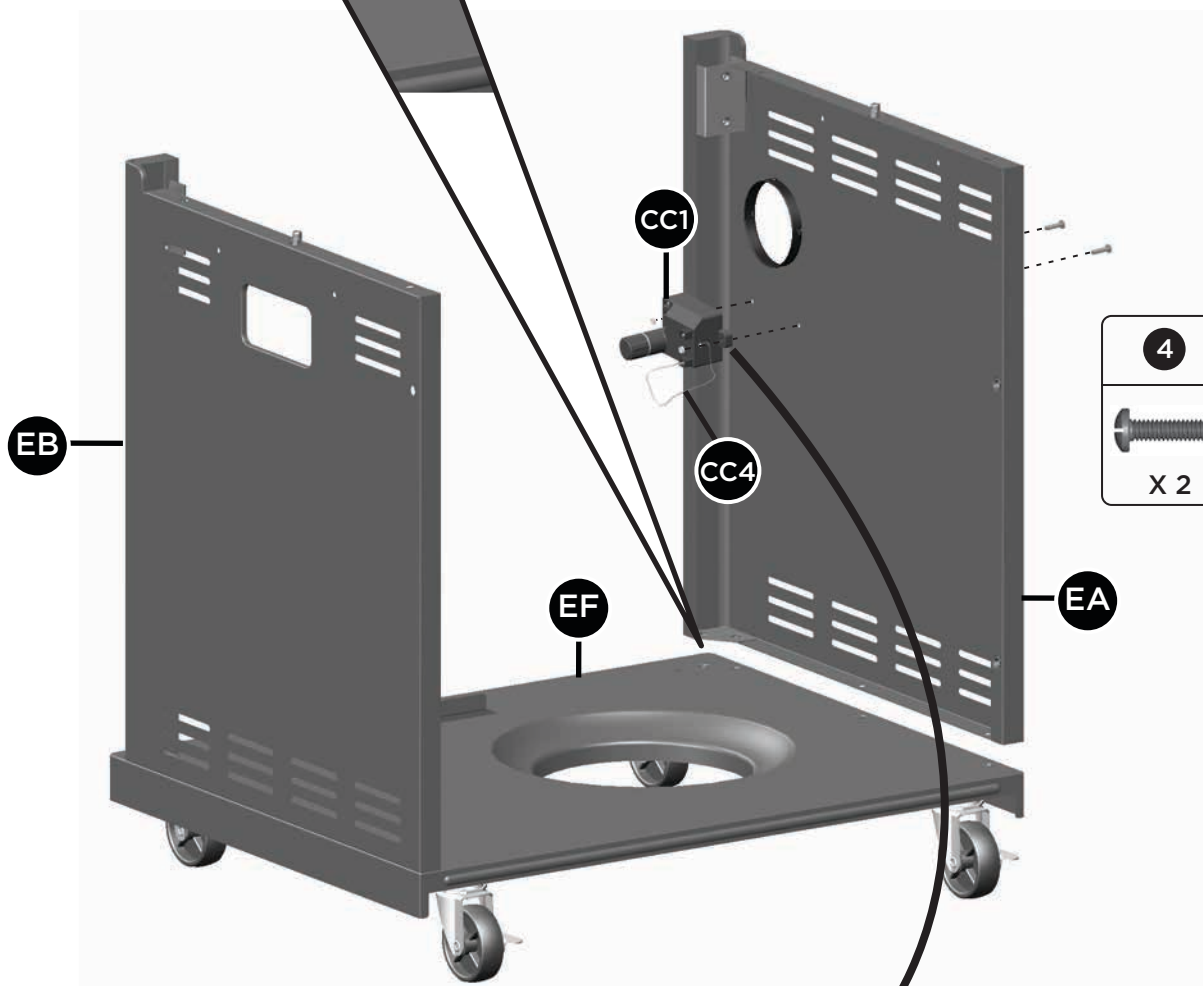
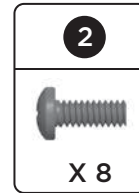
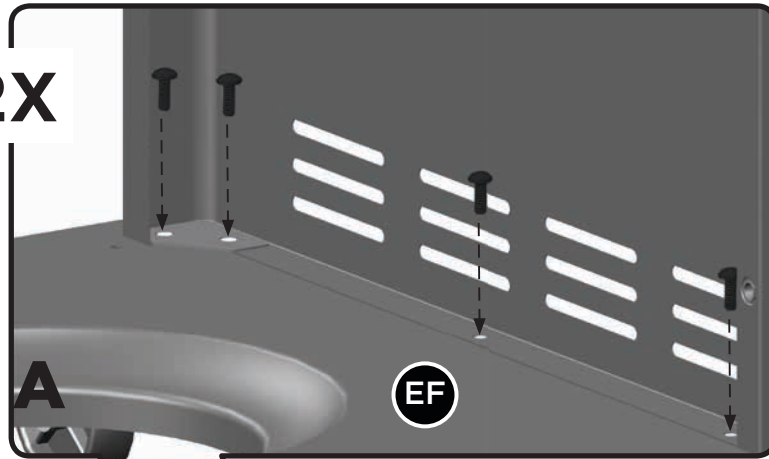

3

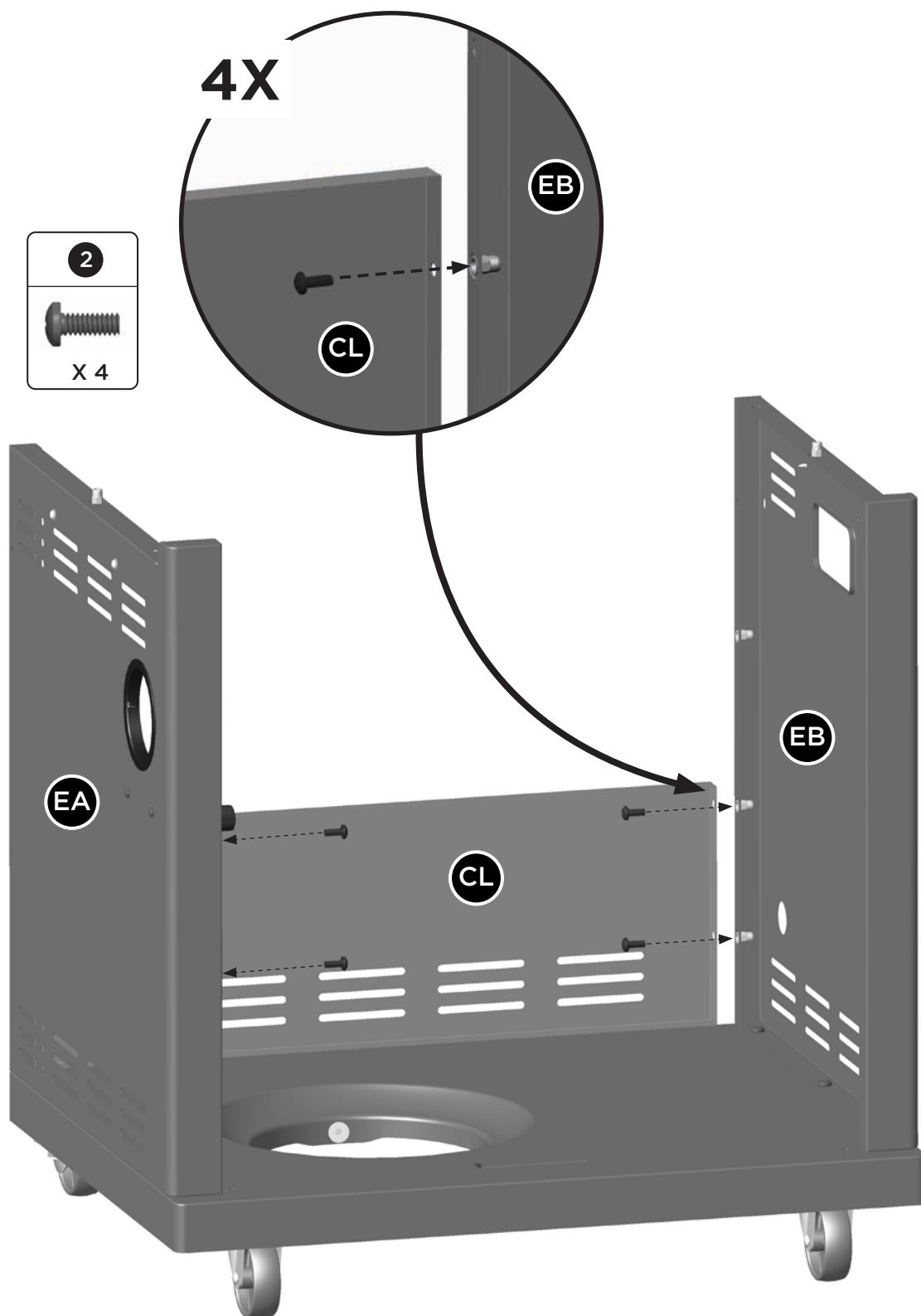



4

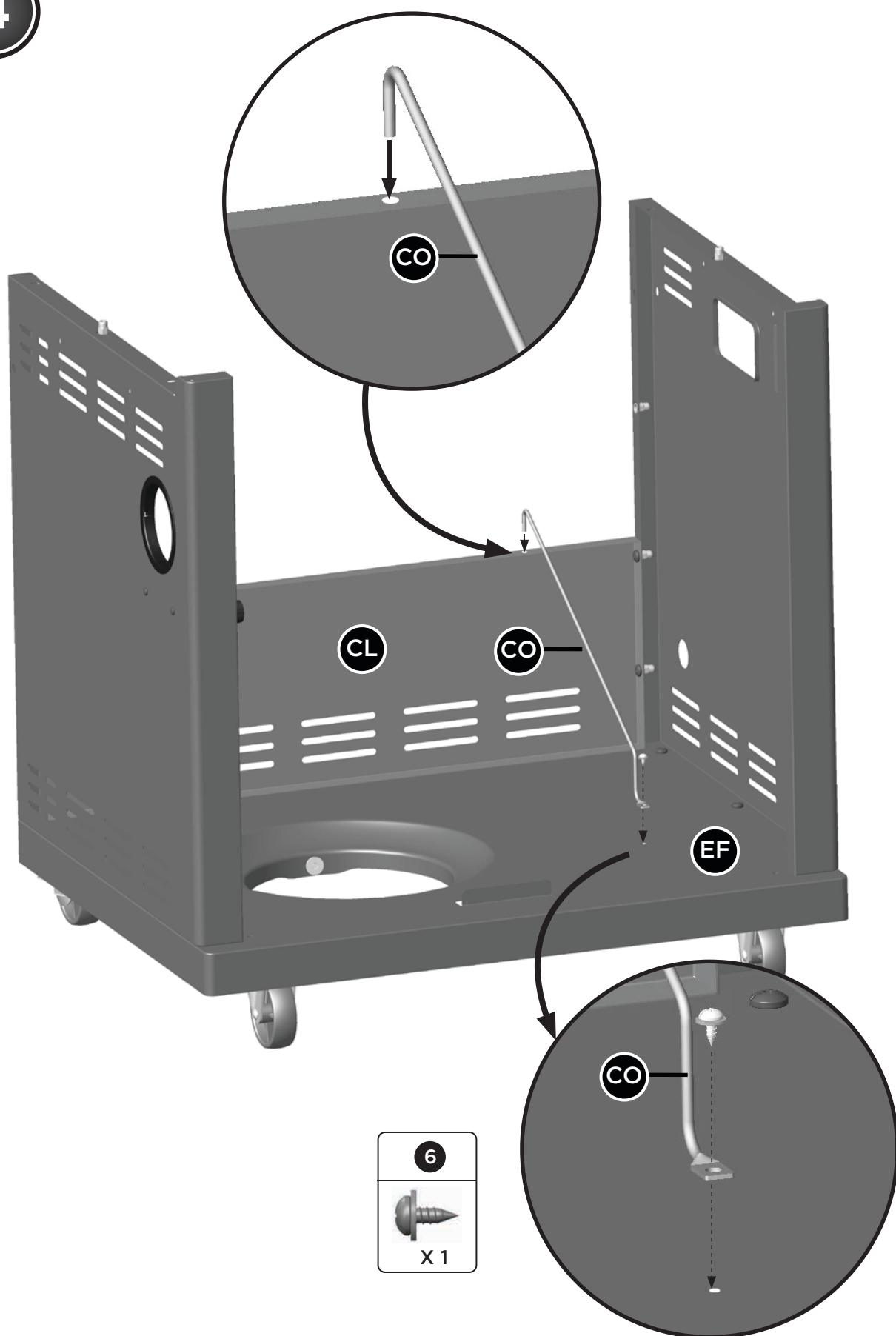

# ASSEMBLY INSTRUCTIONS

5

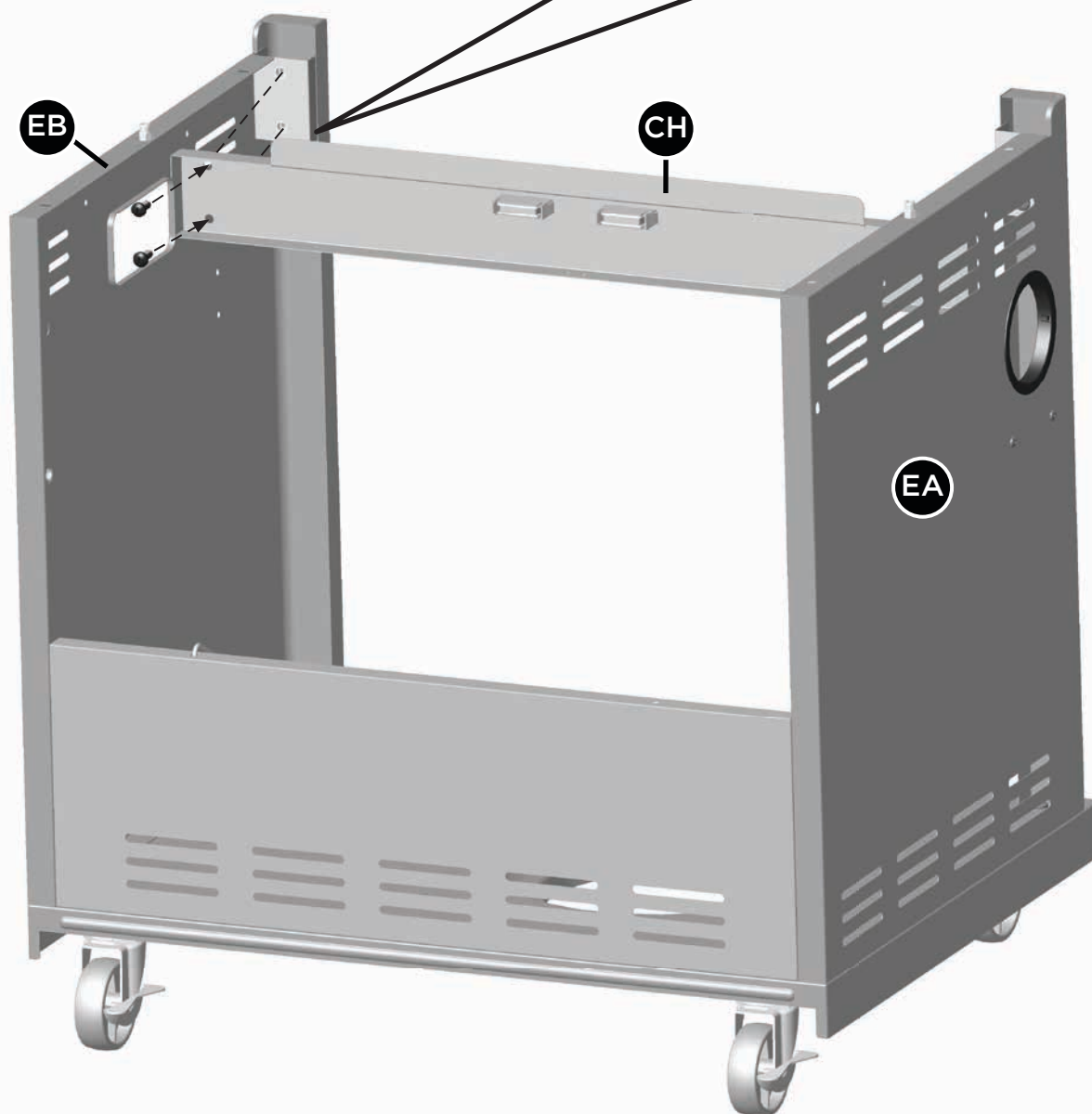
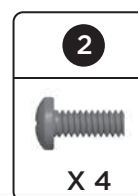
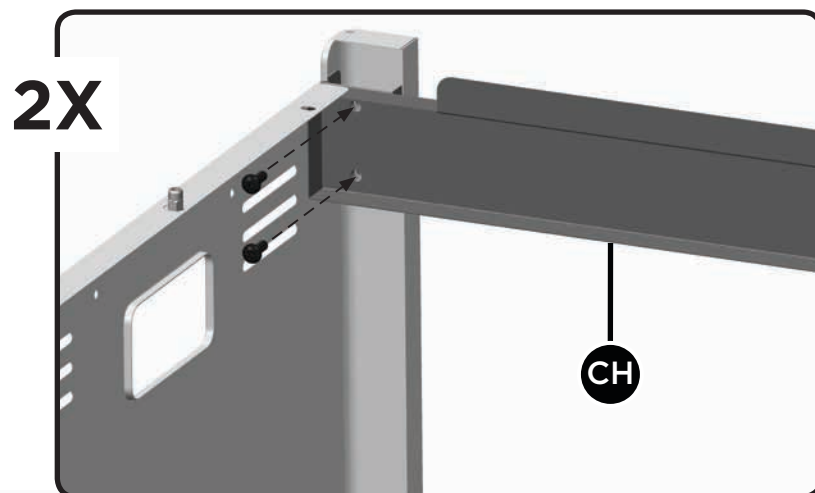

6

A.

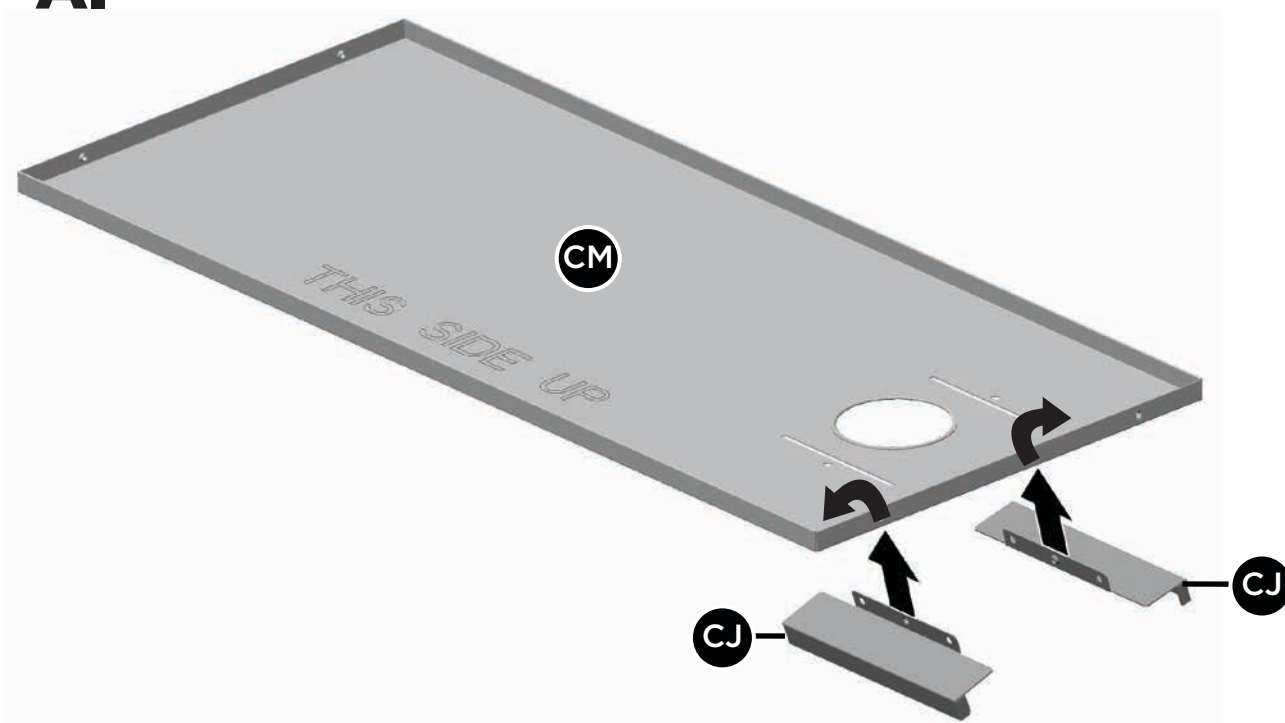

B.

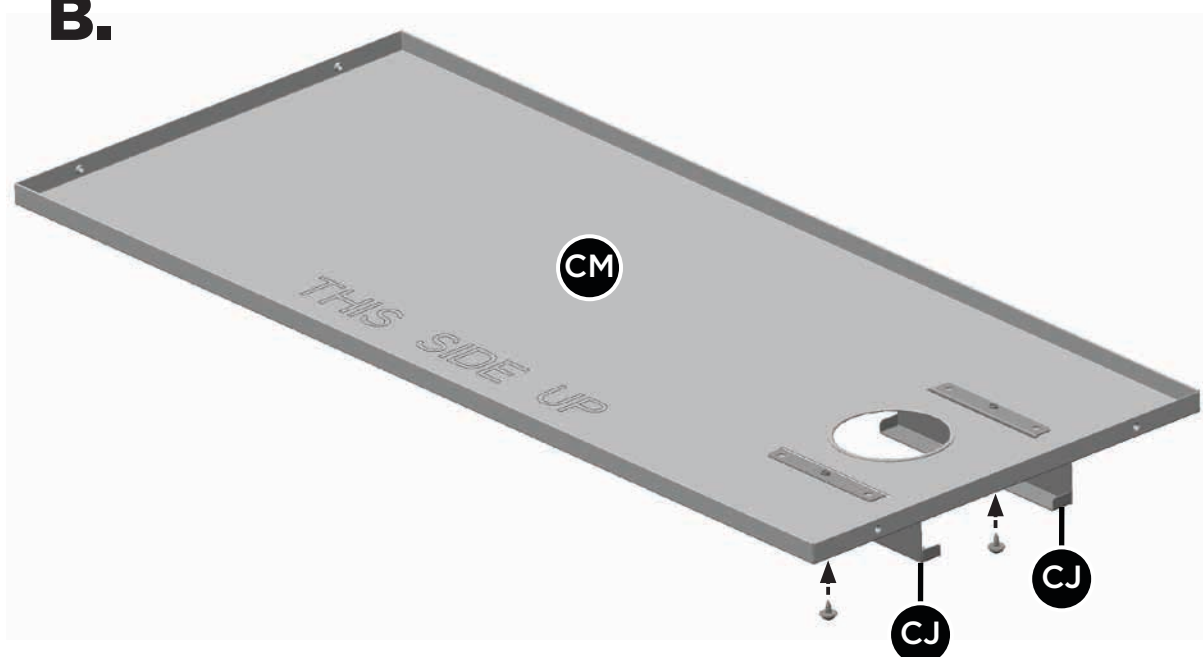

# ASSEMBLY INSTRUCTIONS

6

C.

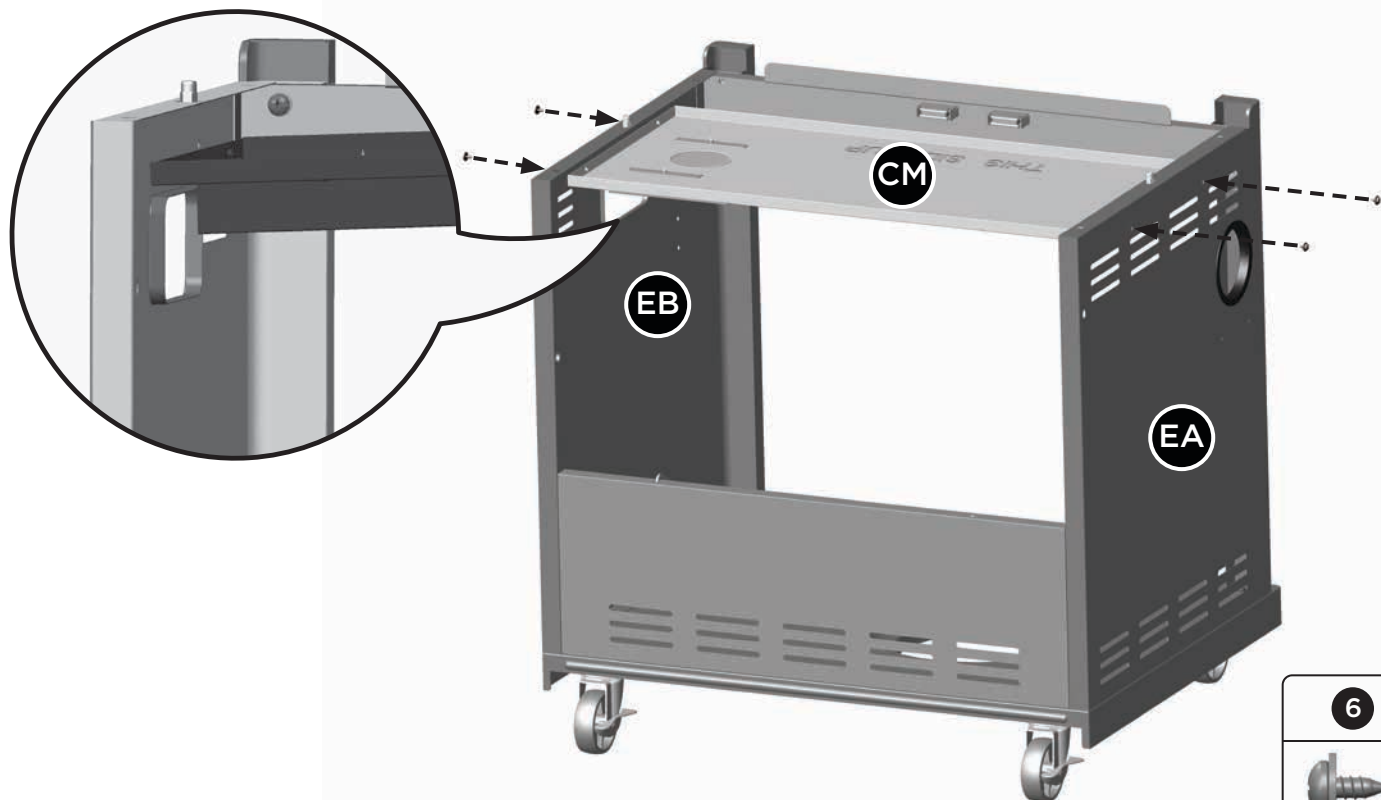

6



X 4

D.

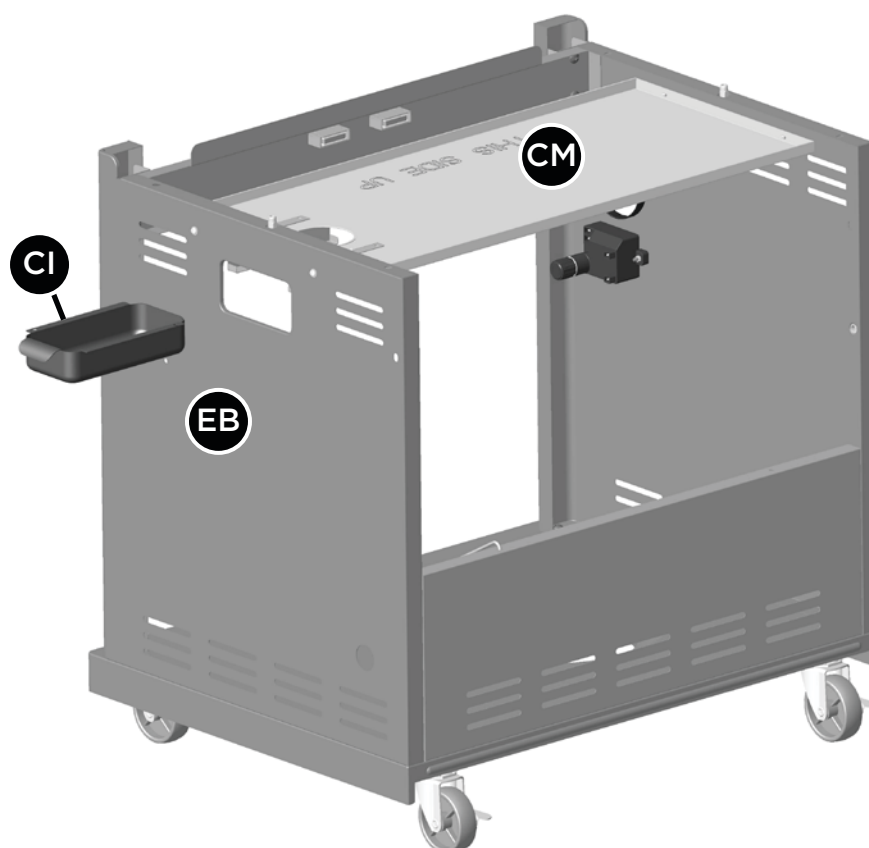

# ASSEMBLY INSTRUCTIONS

7

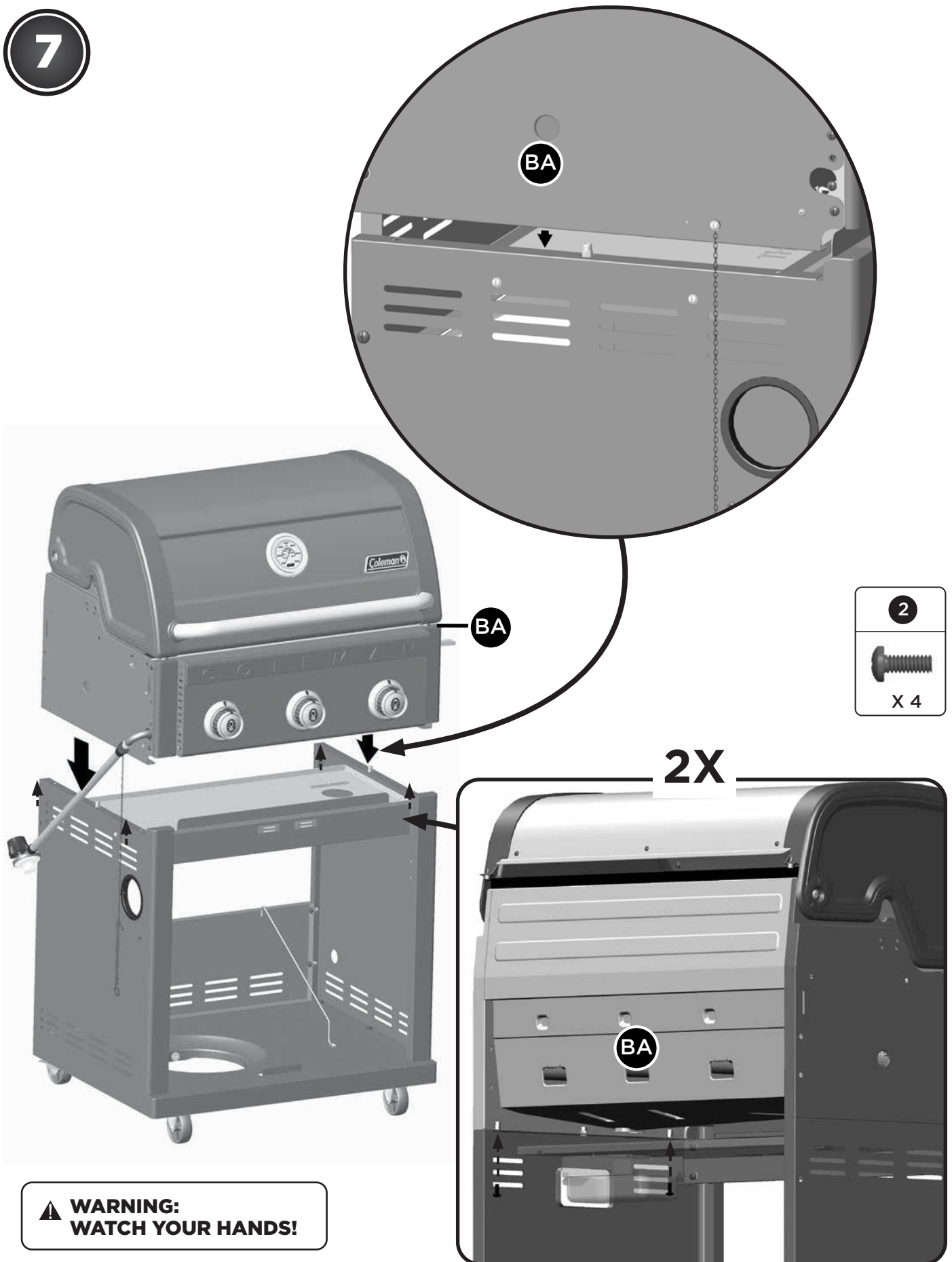

**⚠ WARNING:**  
**WATCH YOUR HANDS!**

## 8

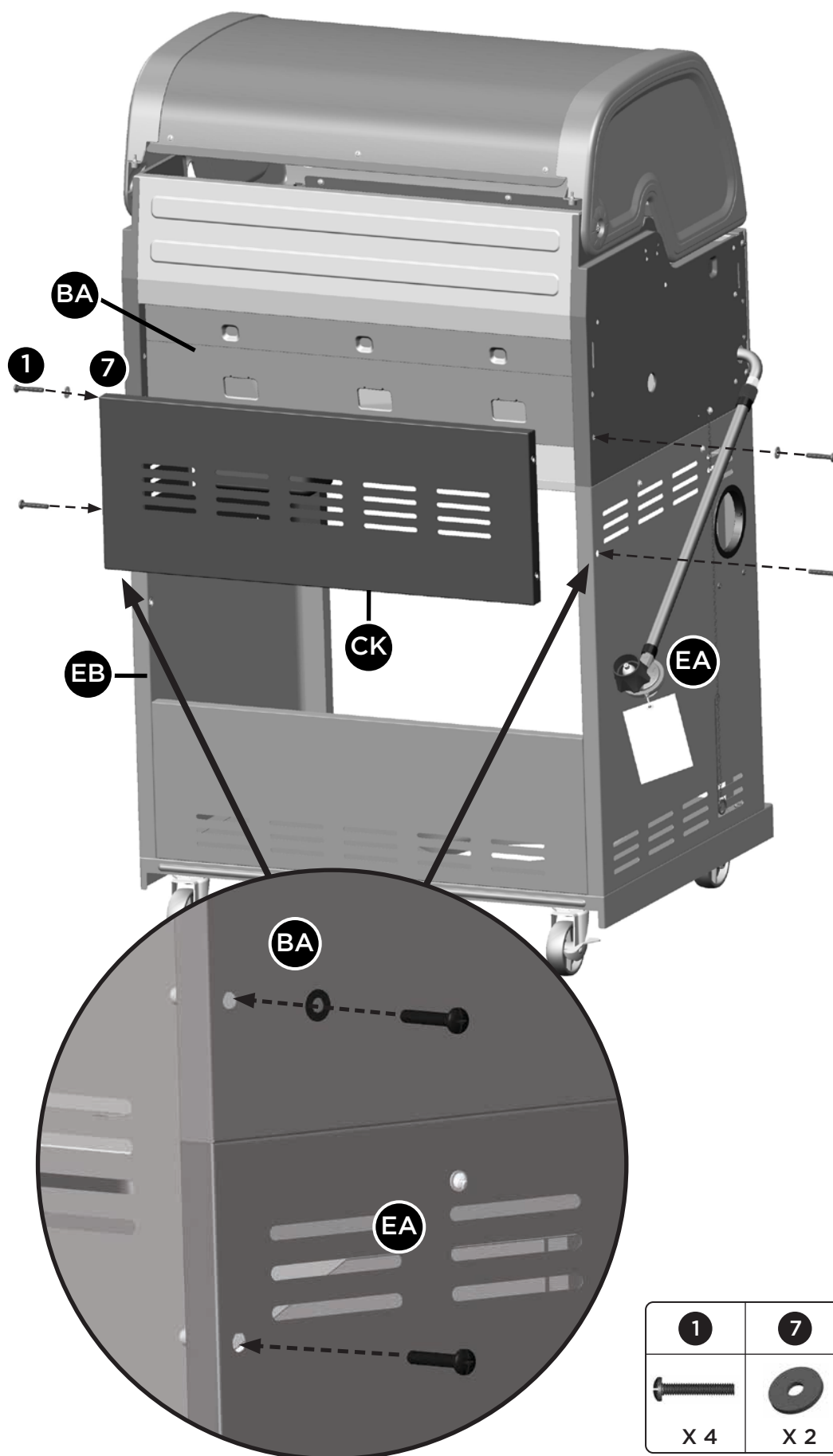

9

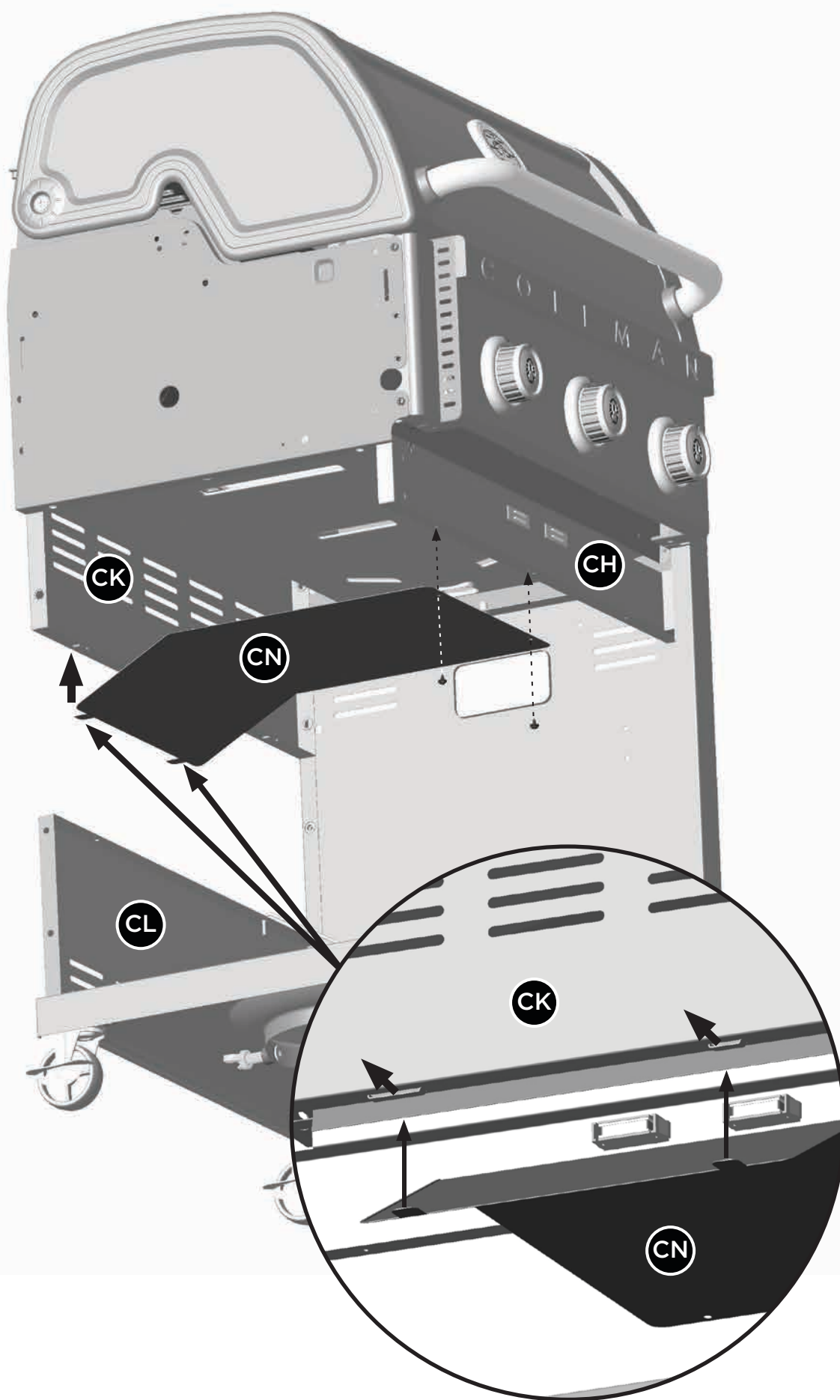
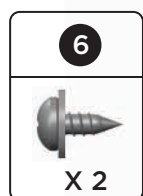



**10**

**A.**

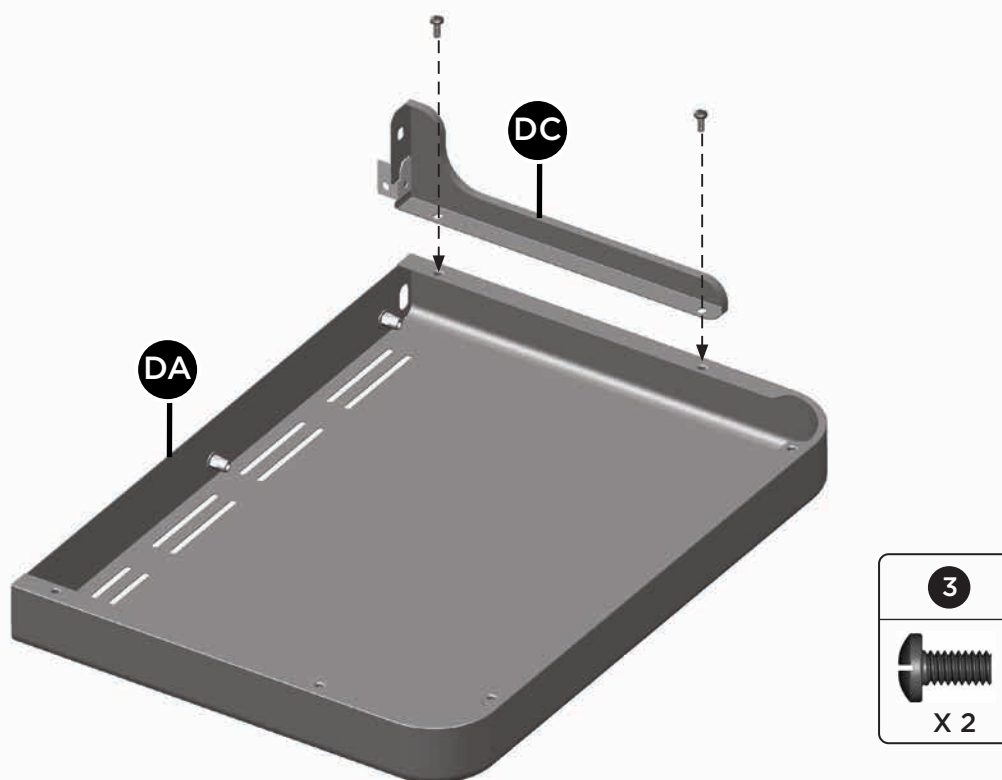

**B.**

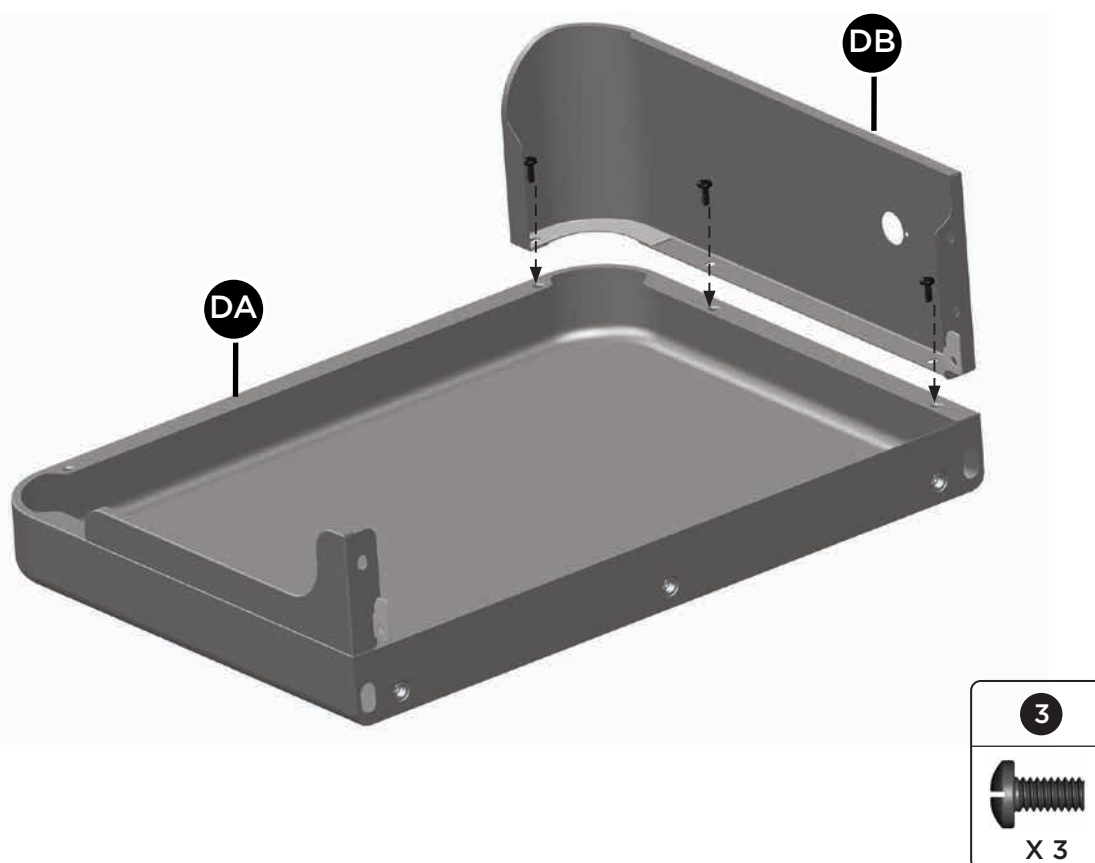



11

A.

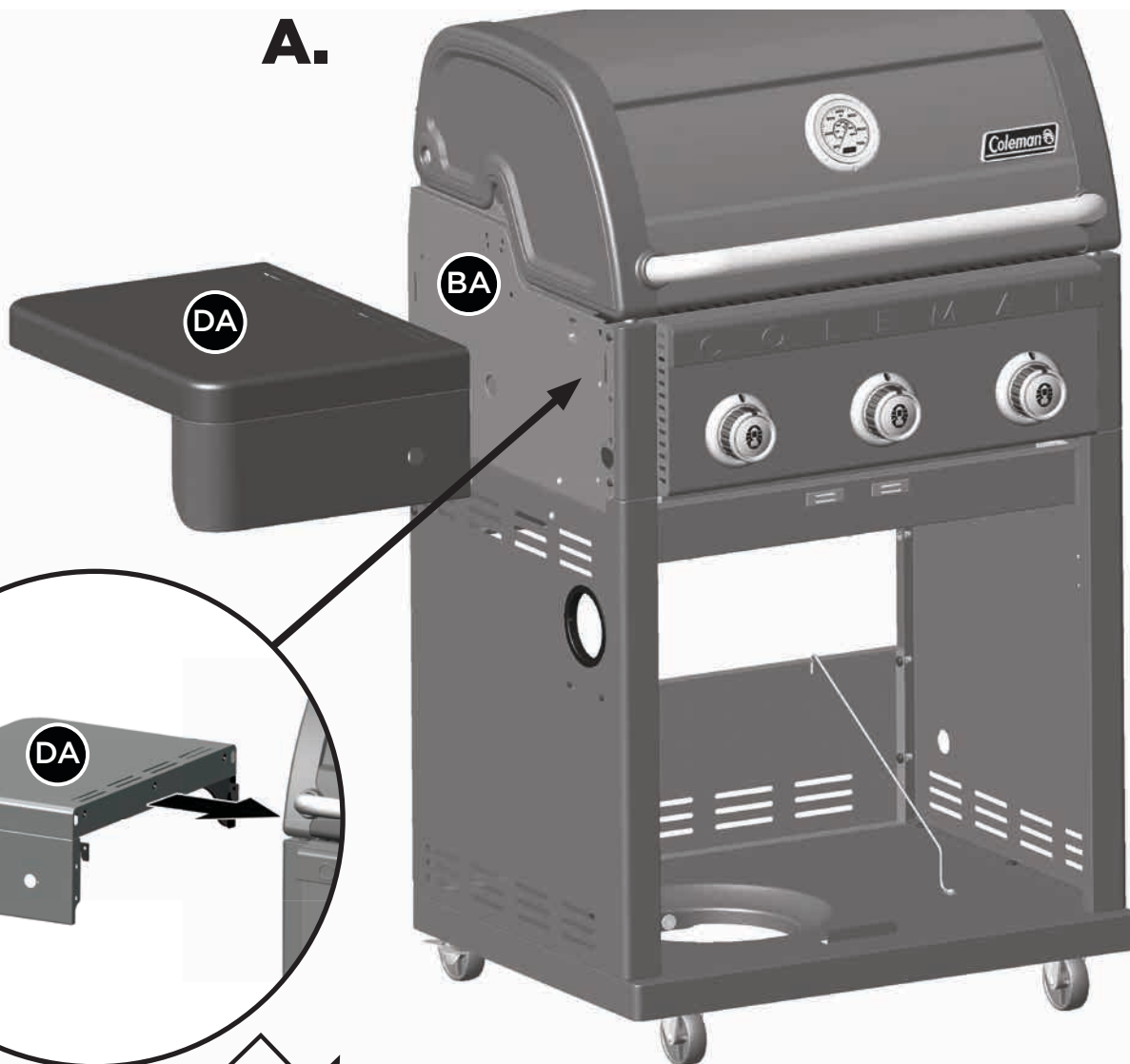

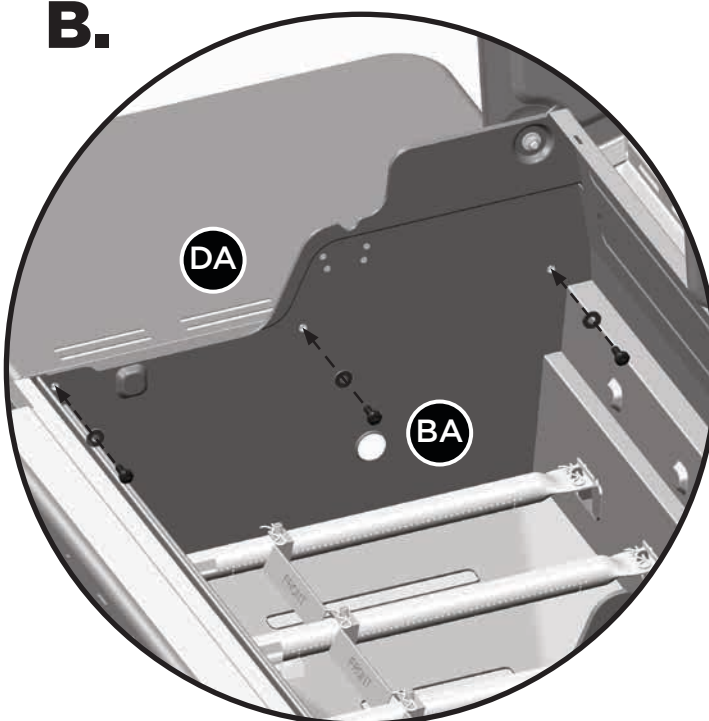

B.



**TIP:**

Ensure that the rubber side of the rubberized washer makes contact with the burner box.

2	7
	
X 3	X 3

11

C.

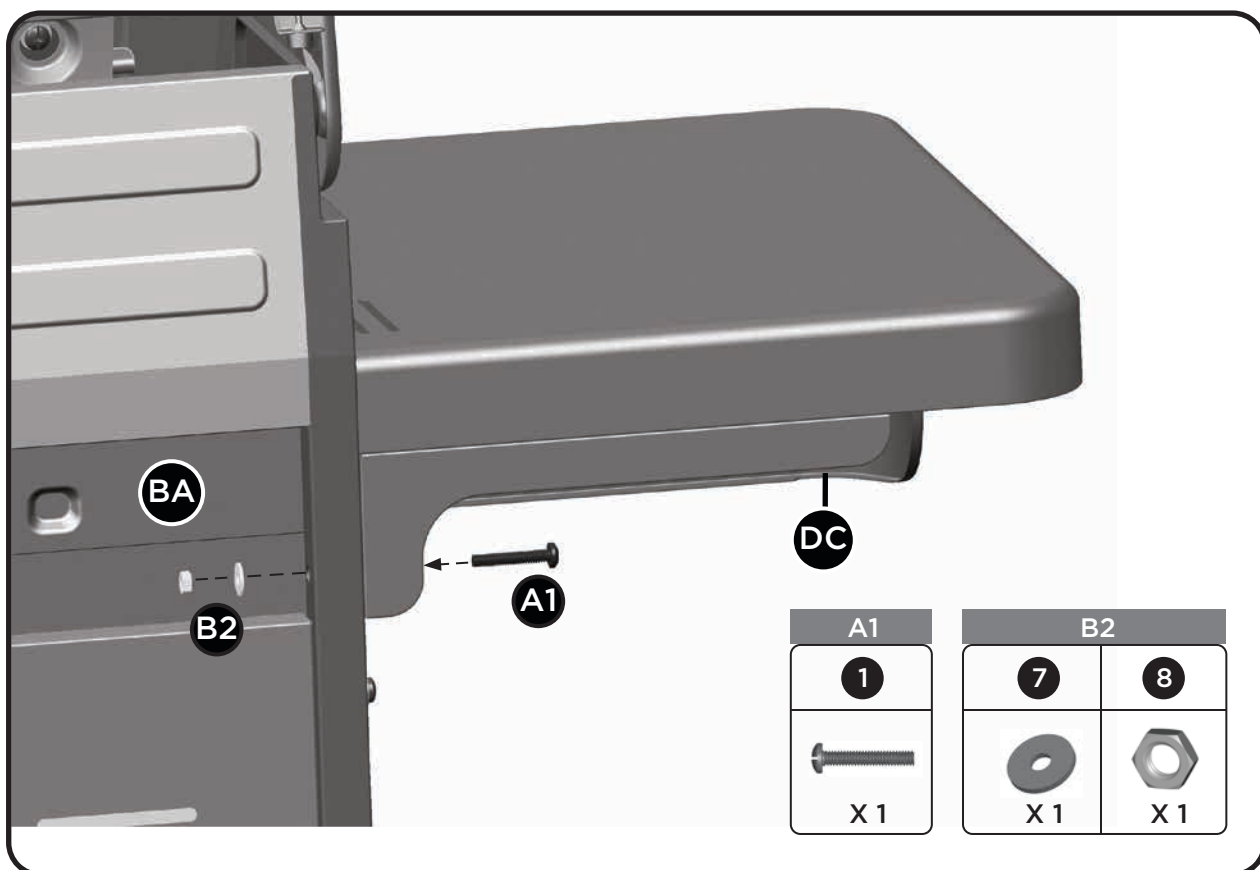

D.

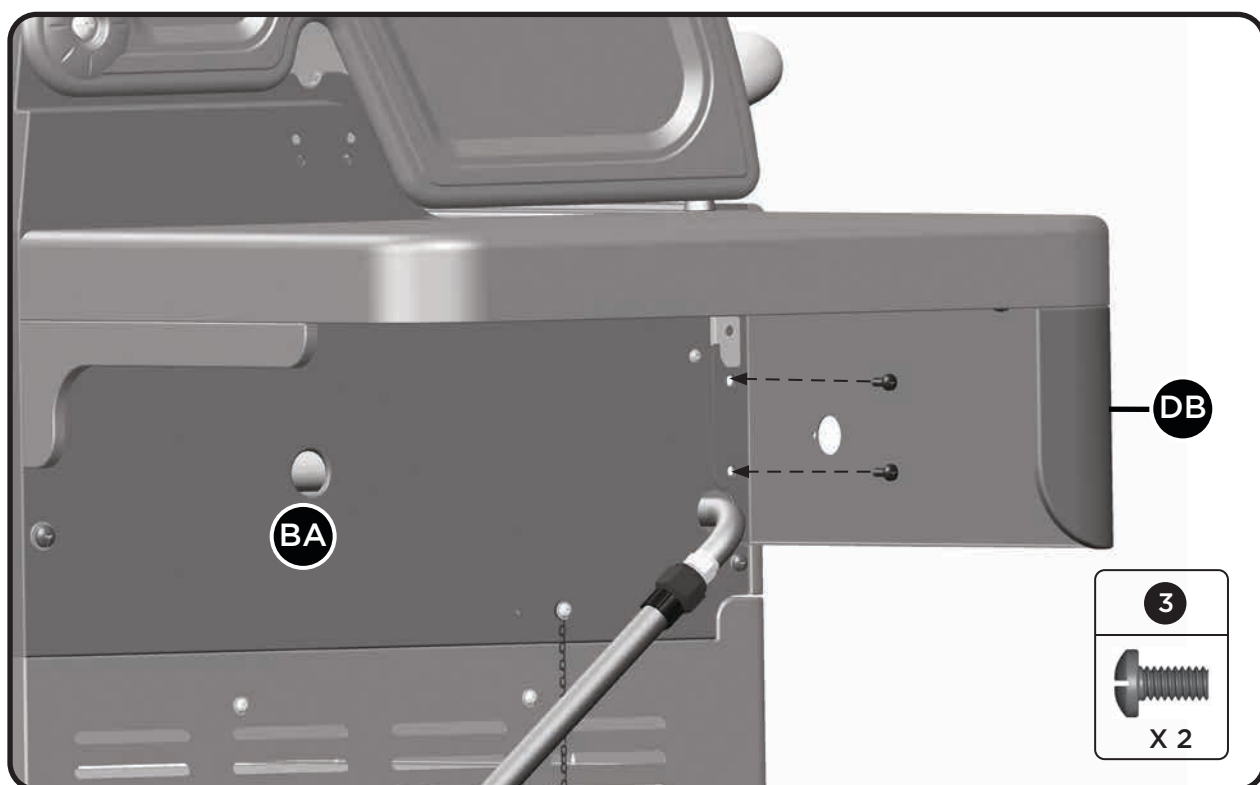

11

E.

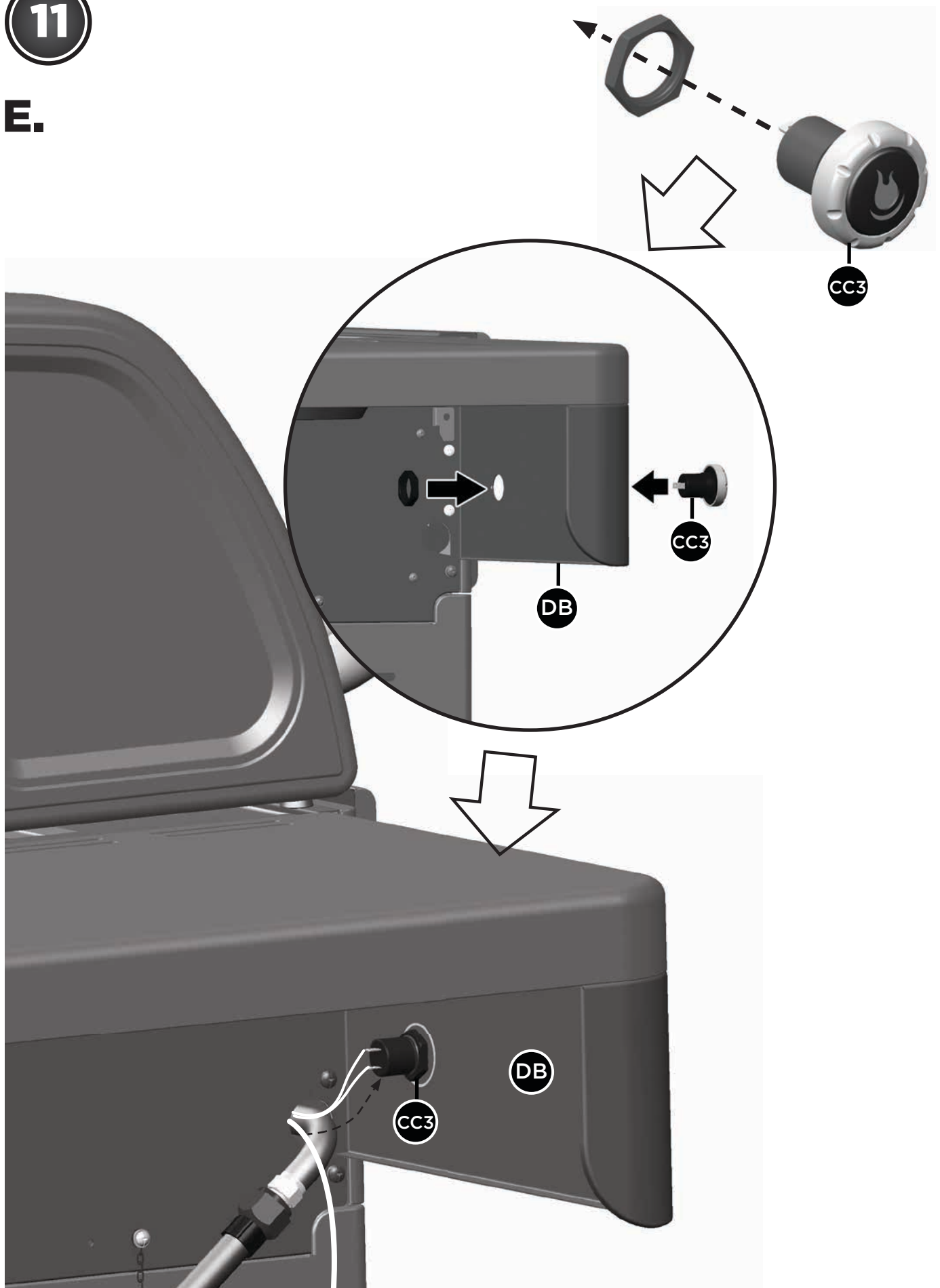

## 12

### Electronic Ignition Assembly

The electrode set for main burner (CD), instastart button (CC3) can be found under the control panel (CG), attached to the manifold (CA). Insert the main burner electrode (CD) into the electronic ignition (CC1). Insert one "AA" battery into the compartment with the positive end facing outward. Secure using the battery cover (CC2).

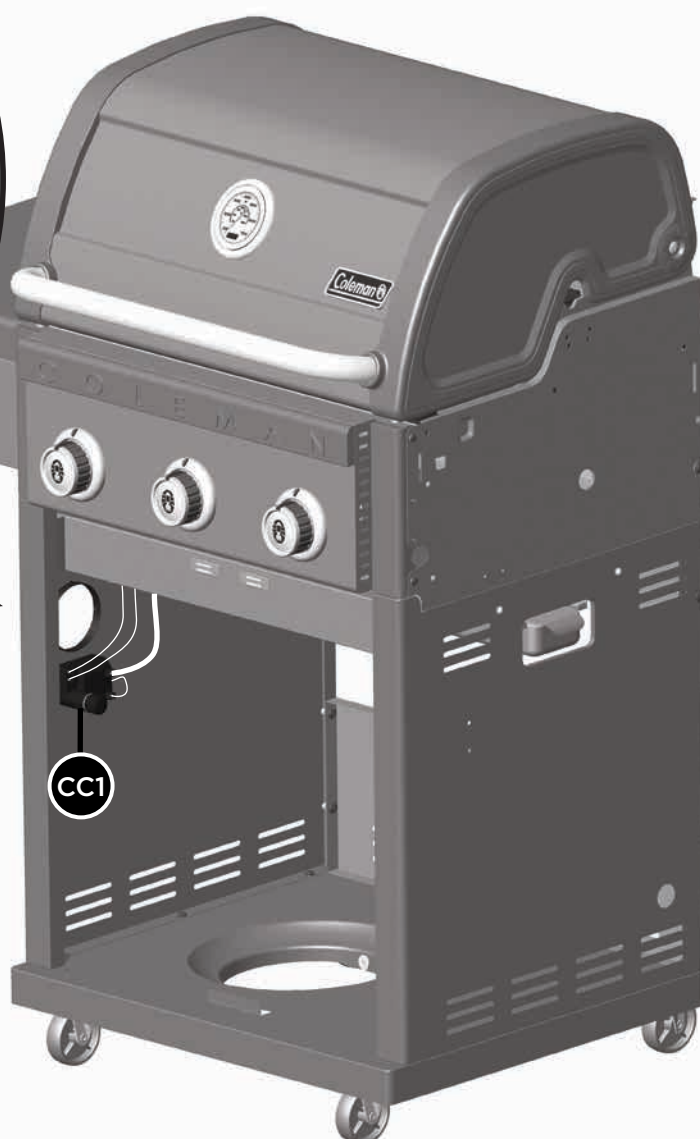
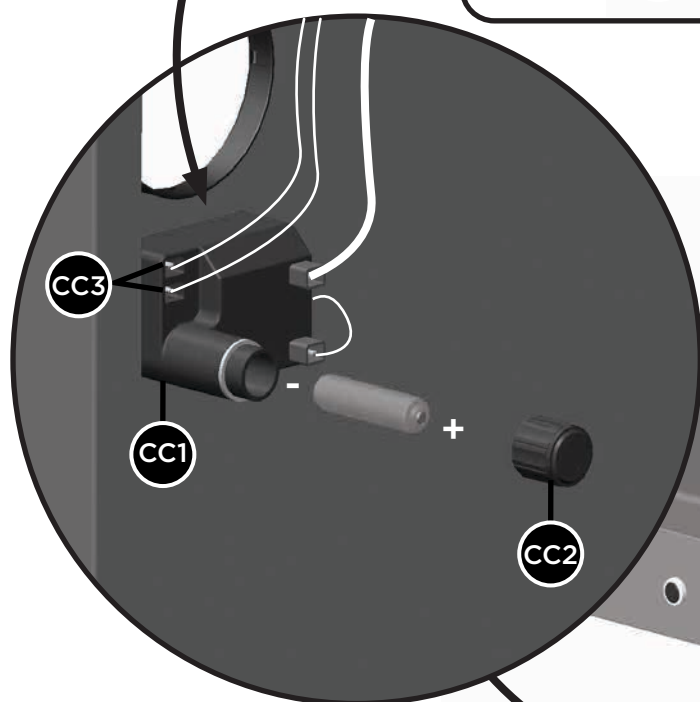
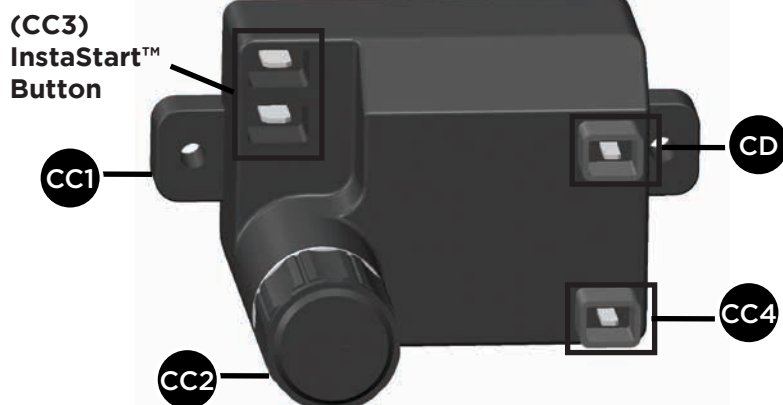

13

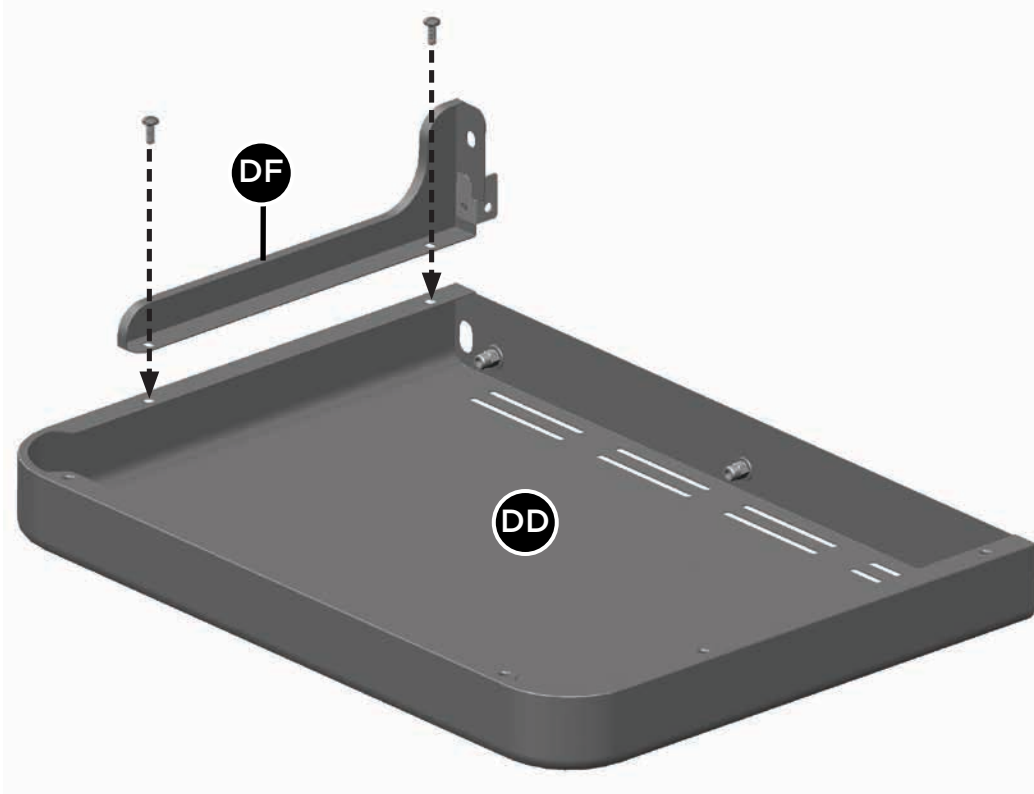

3



X 2

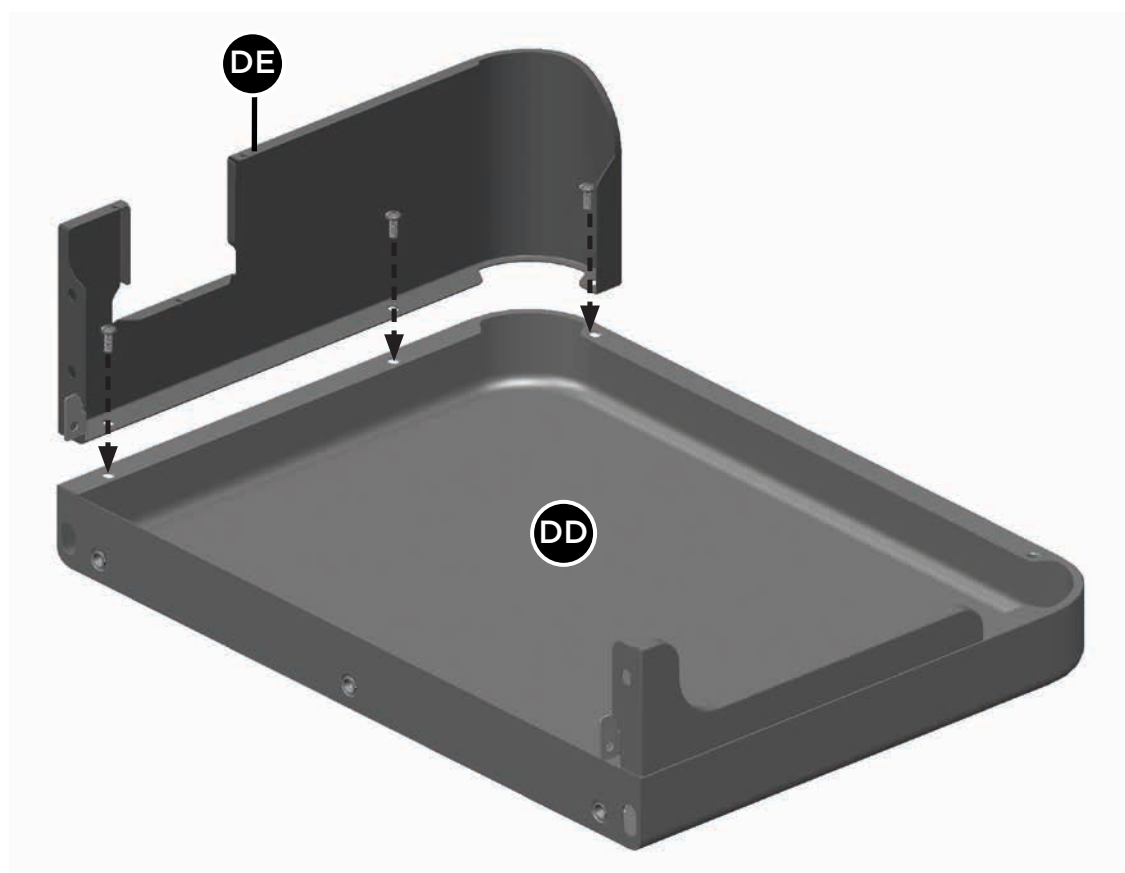

3





X 3

# ASSEMBLY INSTRUCTIONS



14



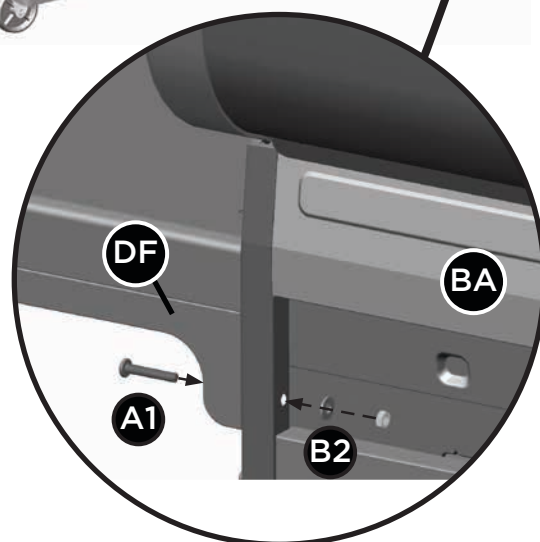
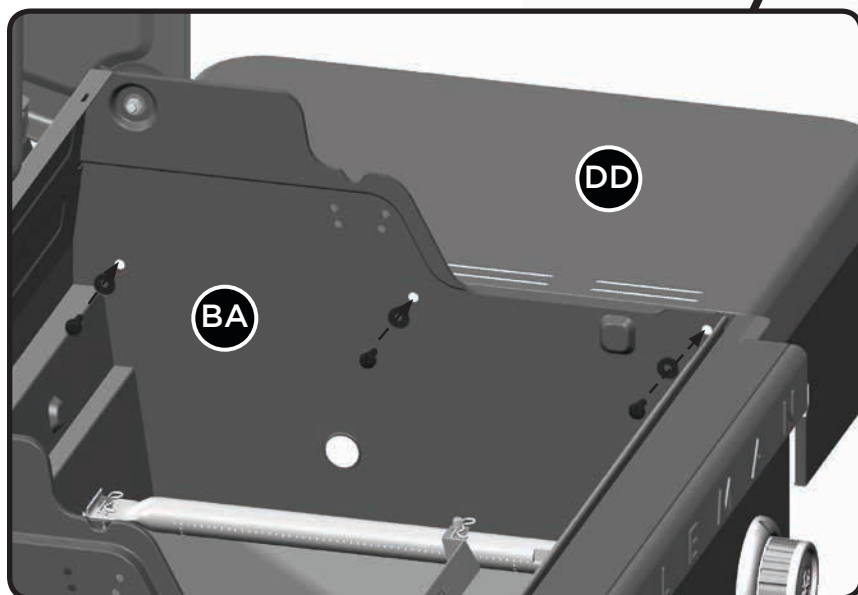

2	7
	
X 3	X 3

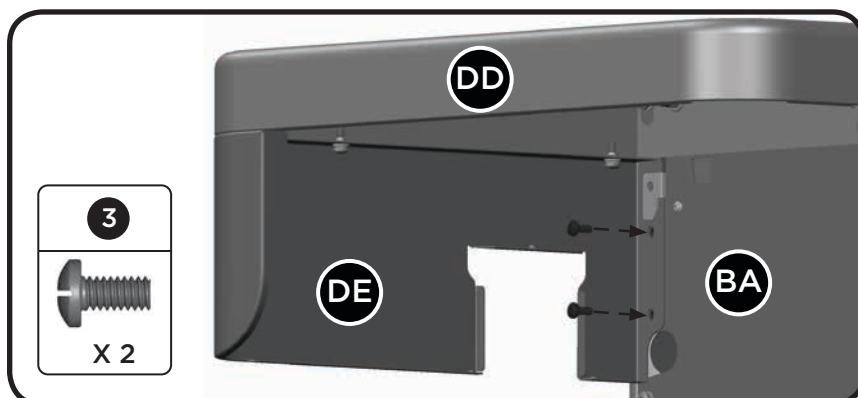

A1
1

X 1

B2	
7	8
	
X 1	X 1



3

X 2

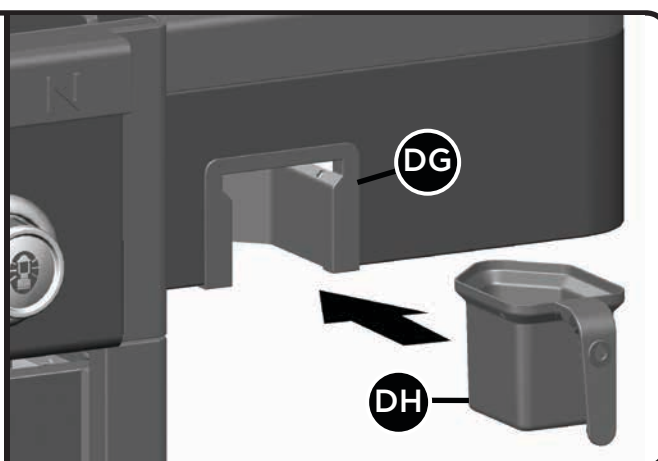
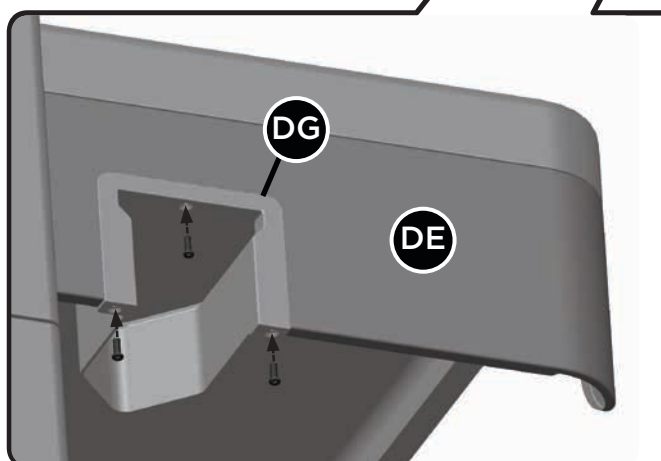

15



5



X 3

**⚠ ATTENTION:**  
EMPTY GREASE CUP AFTER  
EACH USE.

16

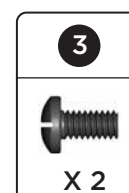
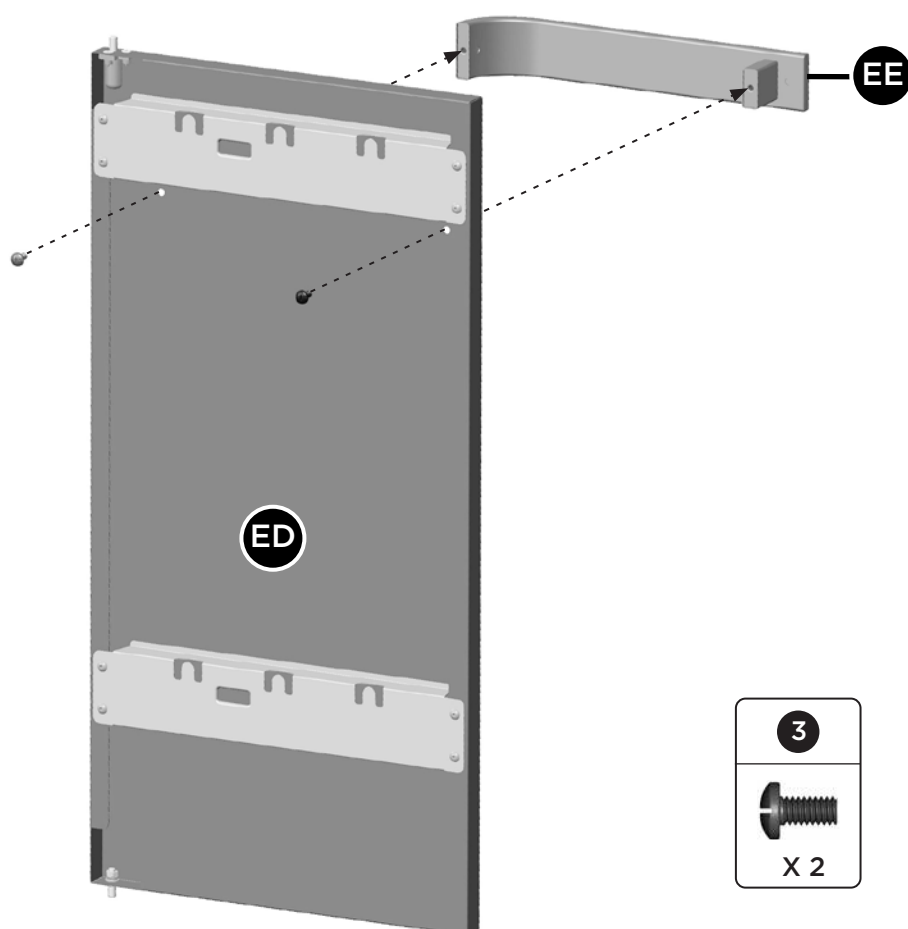
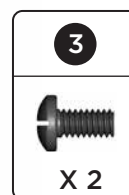
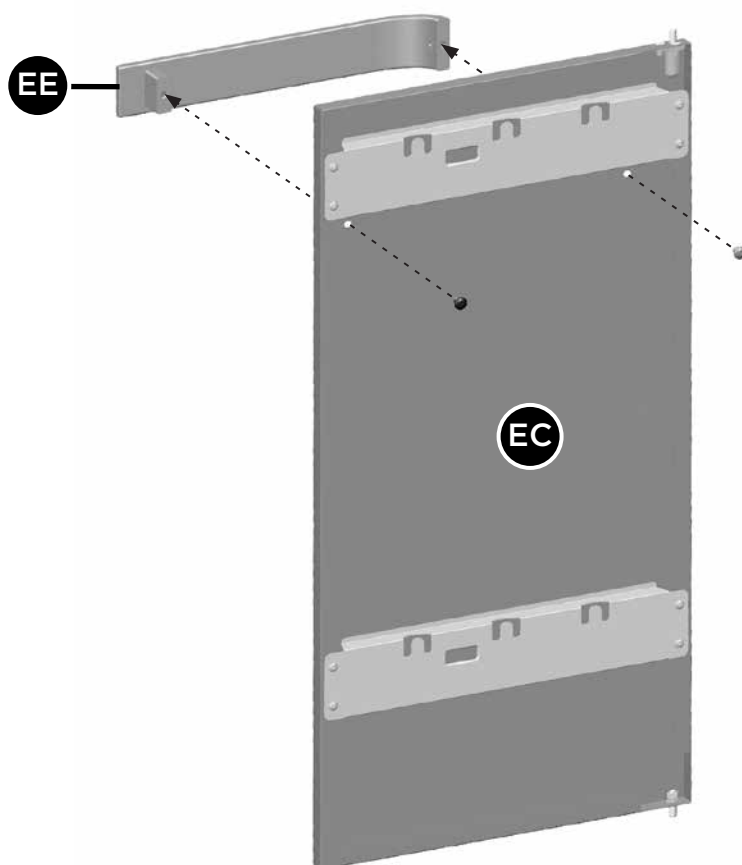



17

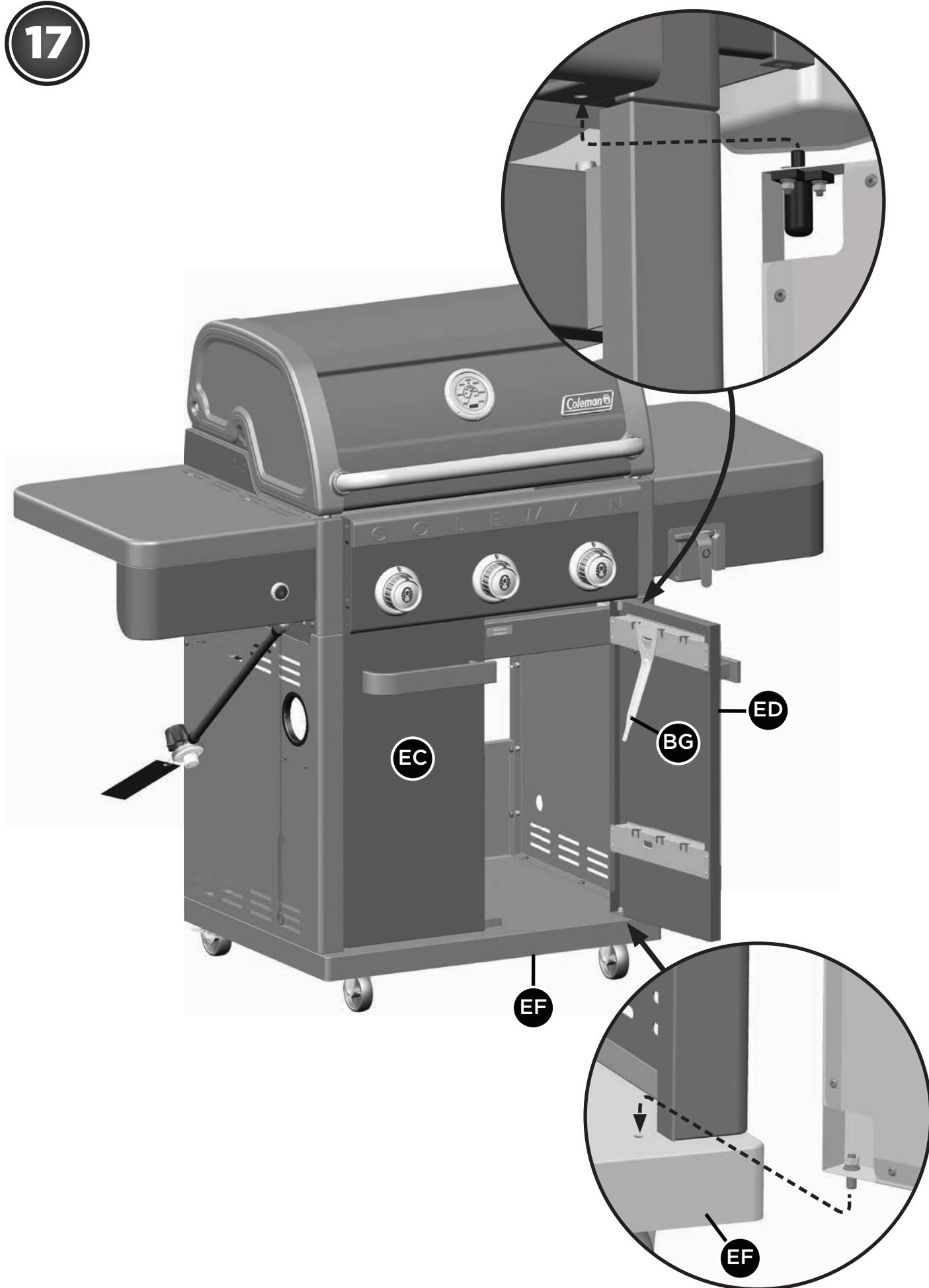

## ASSEMBLY INSTRUCTIONS



### CONVERTIBLE VALVE SYSTEM™

**ATTENTION:** YOUR MODEL includes the CONVERTIBLE VALVE SYSTEM™. If you would like to convert your barbecue from PROPANE to NATURAL GAS, the following kit is required

Convertible Valve System™ Natural Gas  
Conversion Kit - product number:  
85-2261-4 (available at Canadian Tire)

Before completing steps 18 to 23, follow the steps outlined in the CONVERTIBLE VALVE SYSTEM™ instruction manual that accompanied the kit.

18

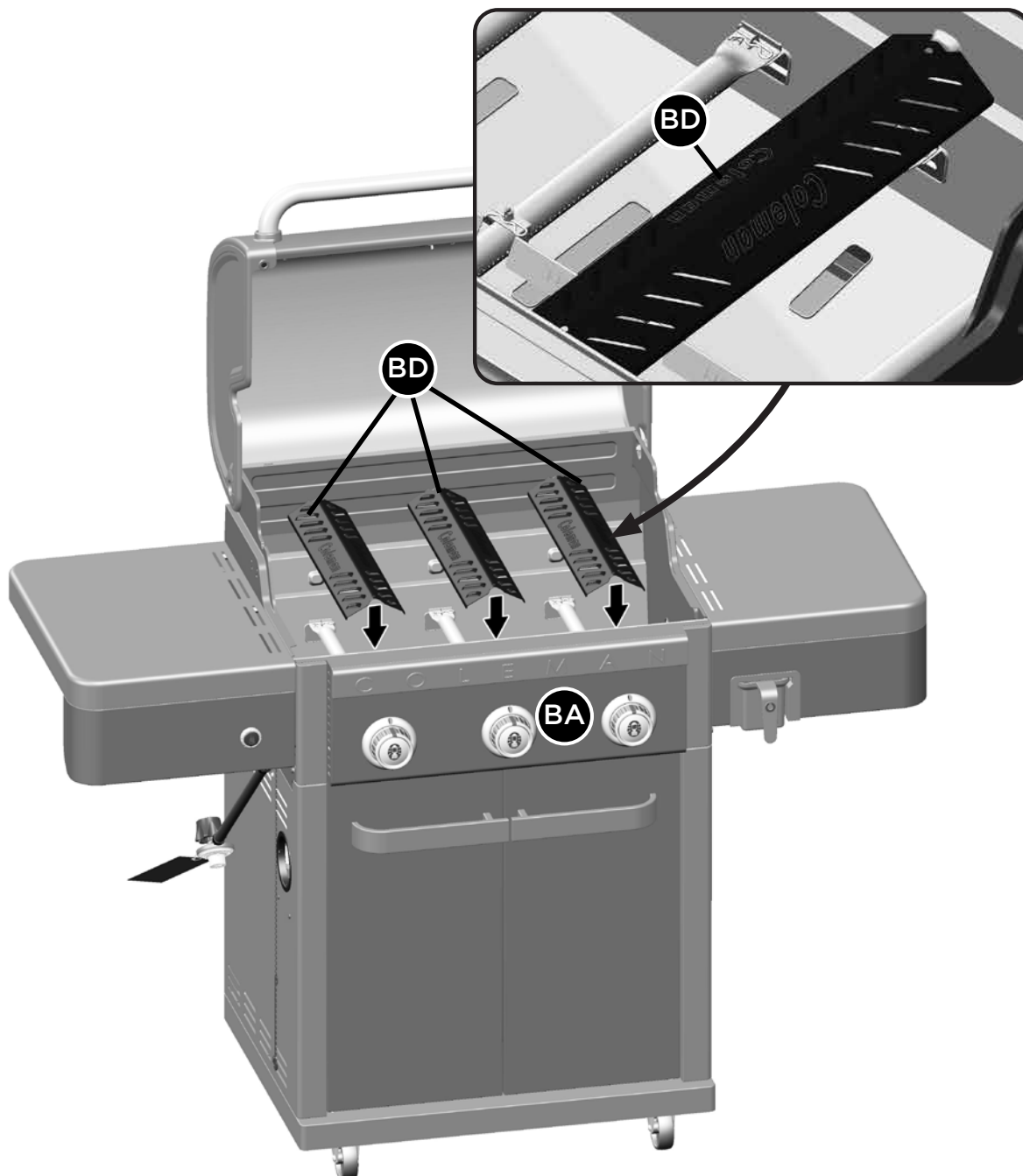

19

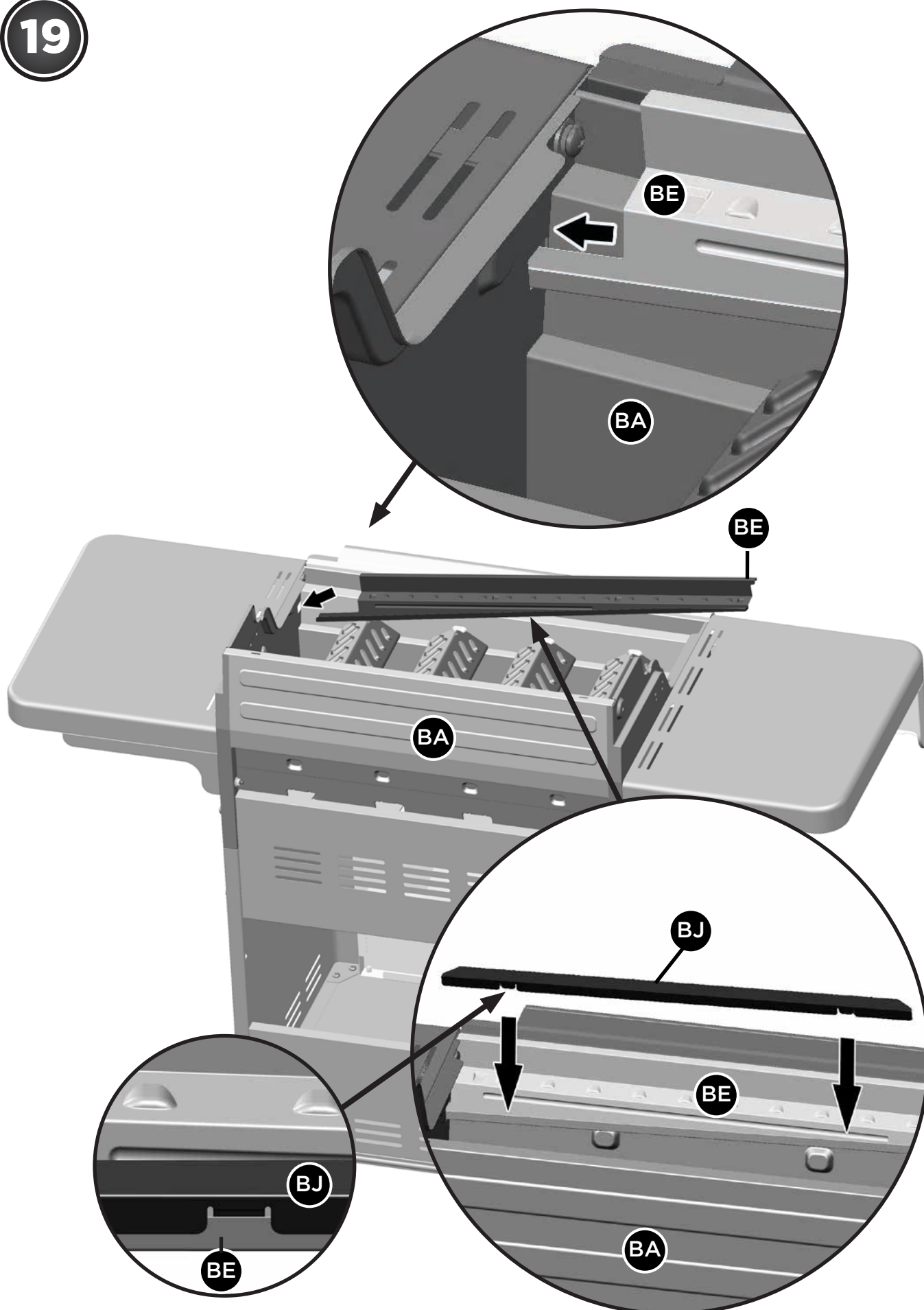

20

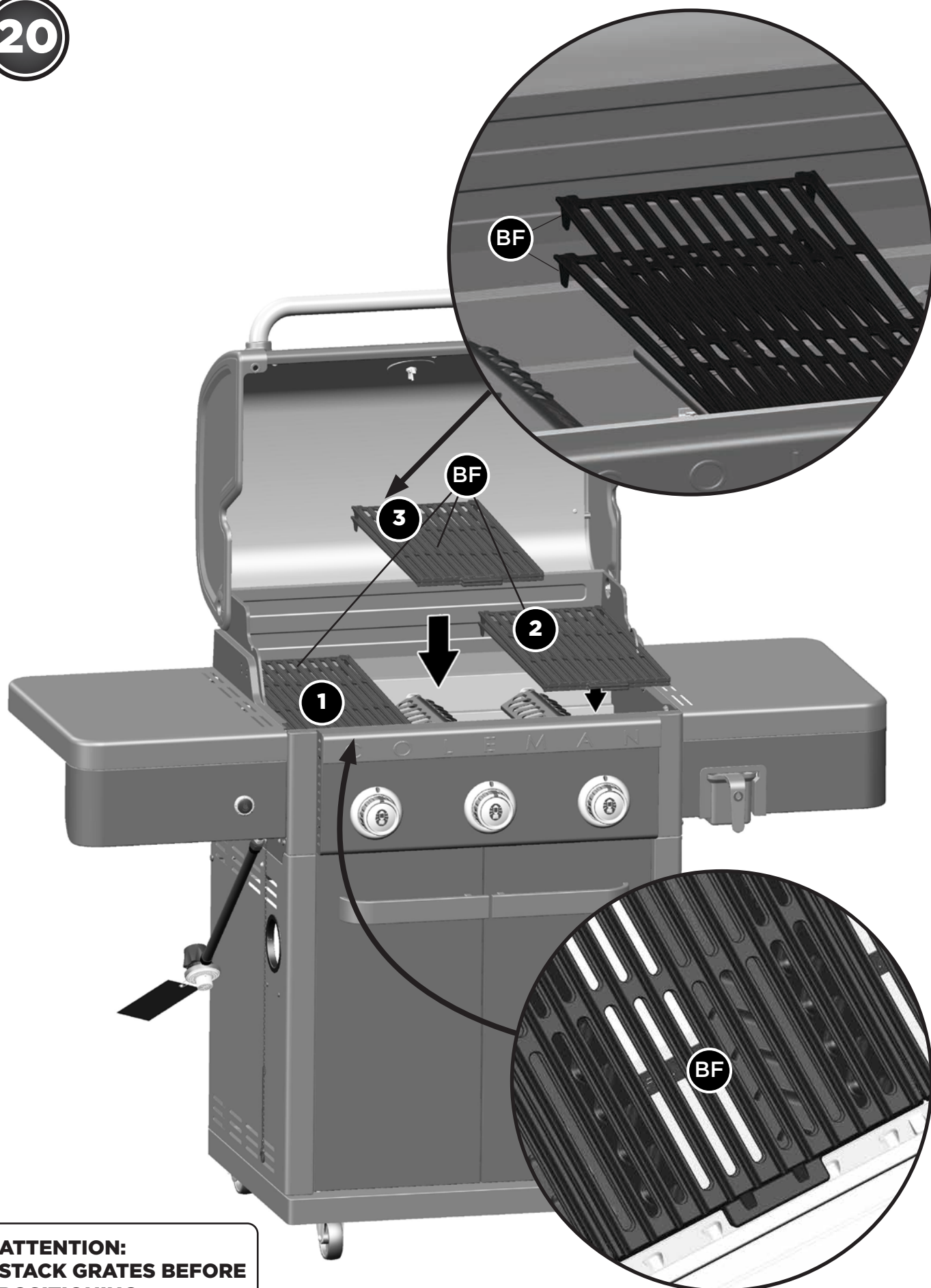

**⚠ ATTENTION:**  
**STACK GRATES BEFORE**  
**POSITIONING.**

21

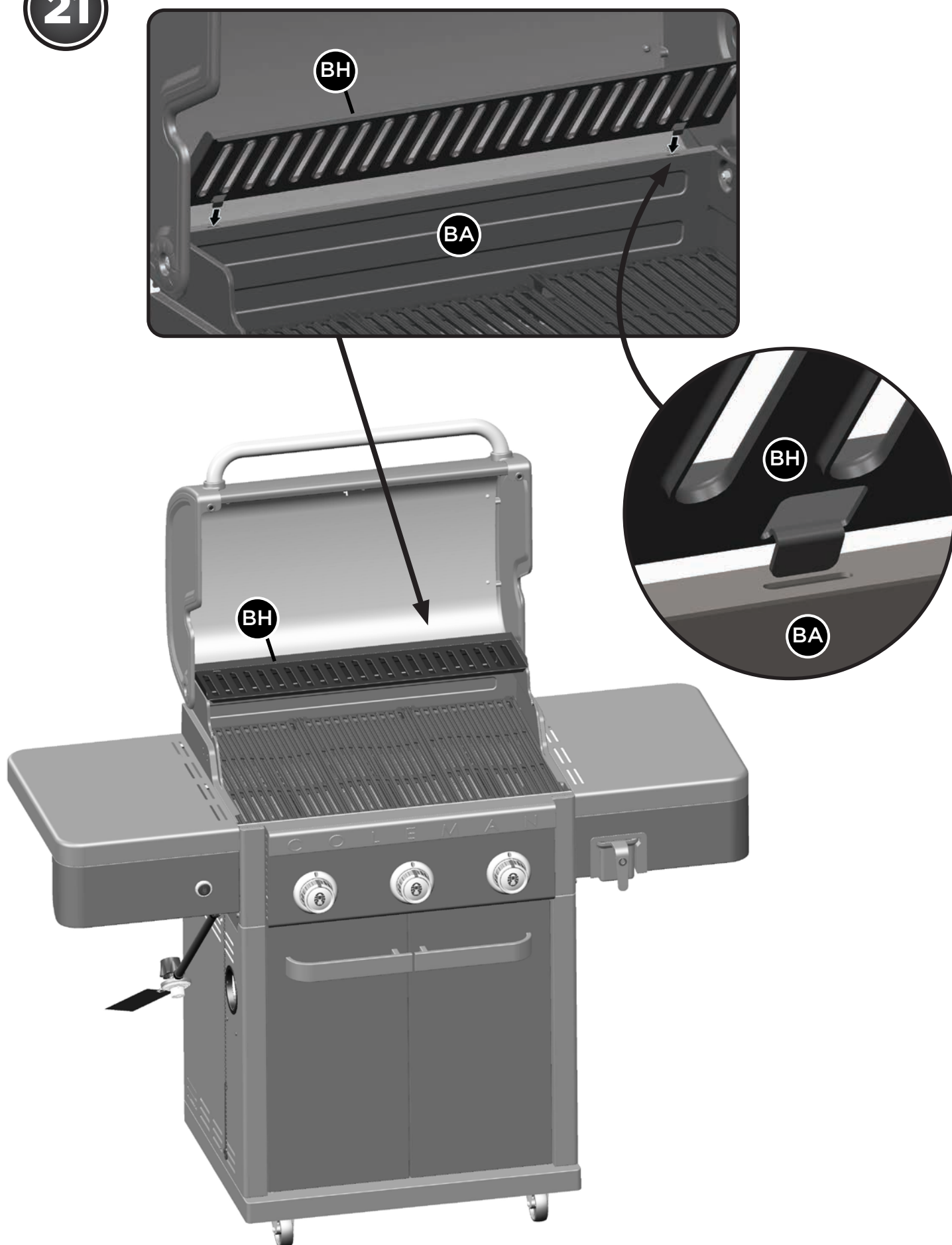



22

**FOR PROPANE MODEL ONLY  
FOR NATURAL GAS MODEL , FOLLOW STEP 23**

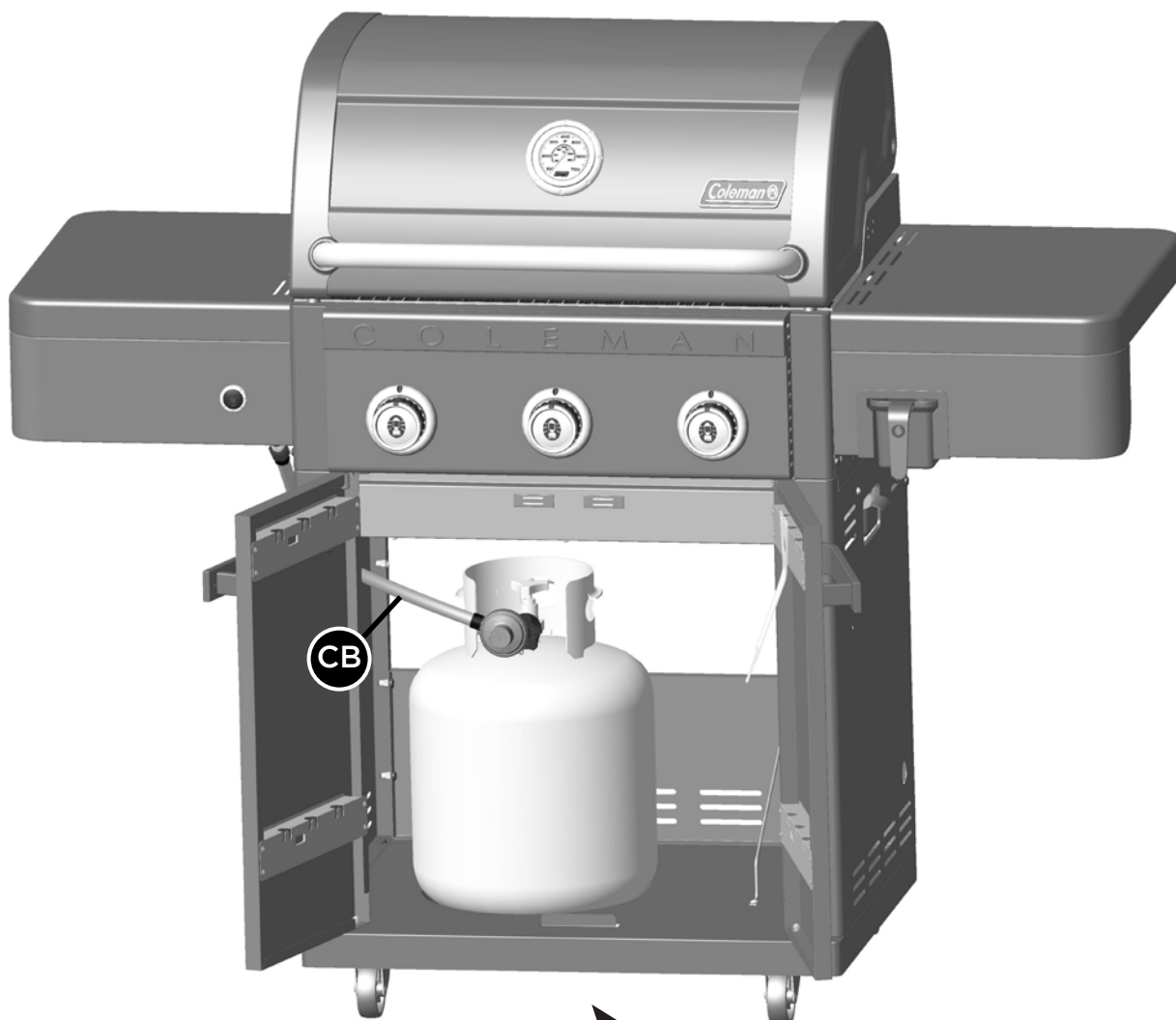

**⚠ ATTENTION:  
DO NOT STORE EXTRA PROPANE  
TANK WITHIN BARBECUE CART.**

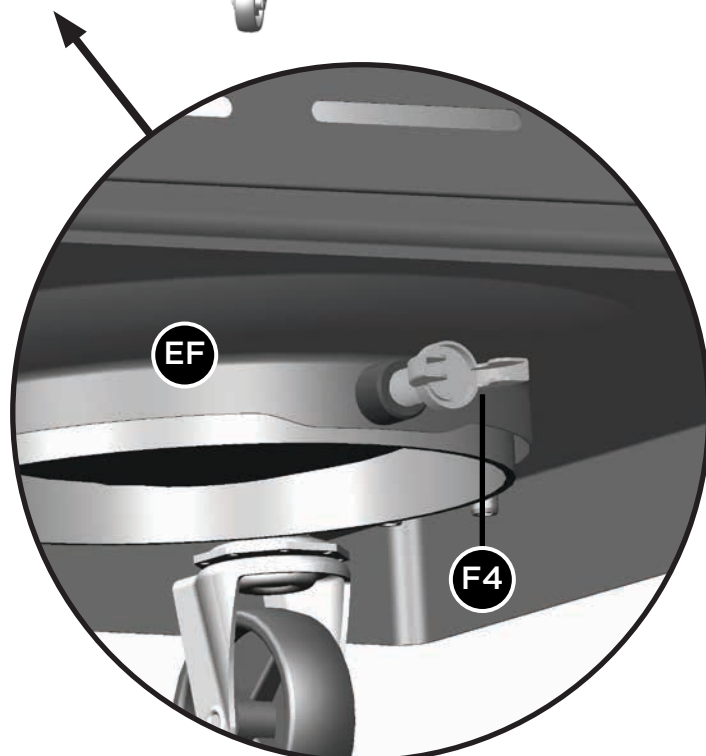

**23**

## HOW TO CONVERT YOUR BARBECUE TO NATURAL GAS

This barbecue was sold PROPANE READY, if you wish to convert your barbecue to Natural Gas you must purchase the Natural Gas Conversion Kit sold at Canadian Tire, product #85-2261-4.



### IMPORTANT

**Make sure the conversion kit packaging has the following symbol on it:**



**CONVERTIBLE  
VALVE SYSTEM™**

## ADDITIONAL WARNINGS

You have now completed the Assembly of your COLEMAN® REVOLUTION™ BARBECUE.

### NEXT STEPS:

1. Position your BARBECUE
2. Read SAFE USE & CARE MANUAL
3. Perform Grill Safety Check-list

#### ⚠ **WARNING:**

FOR YOUR FAMILIES SAFETY, DO NOT ATTEMPT TO LIGHT THIS BARBECUE UNTIL YOU HAVE REVIEWED PAGES 4-7 OF THE COLEMAN® SAFE USE & CARE MANUAL. ALL SAFETY AND LEAK TESTS MUST BE PERFORMED BY THE END USER, PRIOR TO LIGHTING THIS BARBECUE.

#### ⚠ **WARNING HOT SURFACES:**

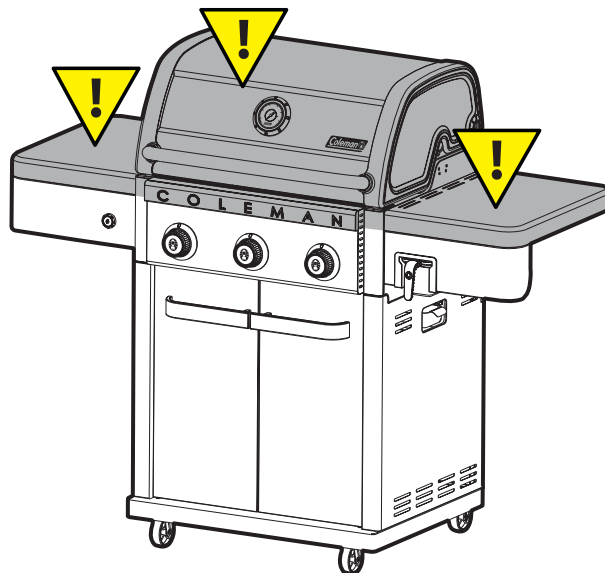

## POSITION YOUR BARBECUE

**Always confirm that this Barbecue is not positioned under** a combustible object (e.g., an awning or umbrella) or in a covered area (e.g., porch or gazebo) before lighting it, to prevent a possible fire.

**Always confirm that this Barbecue is not positioned under** the overhang of a house, a garage or other structure before lighting it. An overhang will serve to deflect flare-ups and radiate heat into the structure itself, which could result in a fire.

**Always confirm that this Barbecue is positioned more than 36" (91.4cm)** away from any combustible materials or surfaces before lighting it, and that no gasoline or other volatile substances are stored in the vicinity of this Barbecue. The temperature of a grease fire or of the radiated heat might otherwise be sufficient to ignite nearby combustibles or volatile substances. Do not position near windows, siding, or fencing.

**Always locate the Barbecue where there will be ample** combustion and ventilation air, but never position it in the direct path of a strong wind.

**Level your Barbecue for optimal performance of Flare-Free Technology™.**





### Join the conversation





[facebook.com/colemangrills](https://facebook.com/colemangrills)



[twitter.com/colemangrills](https://twitter.com/colemangrills)

Manufactured by Winners Products Engineering Ltd.

©2020 The Coleman Company, Inc.

Coleman®,  and  are registered trademarks of  
The Coleman Company, Inc. used under license.